



HIRE CATALOGUE

 Jarvie Plant  JP Vehicle Rentals  JP Accommodation

Hire Solutions Delivered

jarvieplant.co.uk





CONTENTS

WELCOME	04	TELEHANDLERS & FORKLIFTS	44
STRUCTURE & LEADERSHIP	06	ROTATING TELEHANDLERS	52
DEPOT LOCATIONS	08	ROLLERS	58
ABOUT US	10	POWER & LIGHTING	62
INNOVATIVE SOLUTIONS	12	BOWSERS & COMPRESSORS	68
JARVIE DELIVERS	14	SMALL PLANT	73
A DIFFERENT PERSPECTIVE	16	ACCOMMODATION	78
LIFE CYCLE OF A CONSTRUCTION SITE	18	HIGH SECURE ACCOMMODATION	89
SUCCESS IN HEALTH & SAFETY	20	JPX MODULAR BUILDINGS	108
THE ECO FLEET	22	VEHICLES	112
TRANSPORT	24	TERMS & CONDITIONS OF VEHICLE HIRE	118
ACCESS PLATFORMS	26	GENERAL CONDITIONS OF HIRE	123
DUMPERS	30	CATALOGUE INDEX	128
EXCAVATORS	36		

MANAGING DIRECTOR'S INTRODUCTION



David Jarvie
Managing Director

Welcome to the 2026 edition of our Hire Catalogue. This year, we are proud to present our full range across Plant, Handling & Access, Accommodation & Welfare, Power, and Vehicle Rental - supported by one of the youngest, most capable fleets in the industry.

Over the past year, we have significantly expanded our fleet, introduced innovative low-emission solar and electric machinery, vehicles, and accommodation units, and invested heavily in staff training to uphold the highest standards of safety, service, and technical expertise.

Highlights from the year include our Open Day at Newbridge - where customers explored a wide selection of our latest equipment and vehicles first hand.

Our continued commitment to sustainability showcased on the SSS stand at Plantworx, and the installation of 360-degree cameras across our delivery HGV fleet.

Beyond our core business, we remain deeply committed to giving back to the communities we serve. Throughout the year, we have supported a range of charitable and local initiatives, with a particular focus on raising awareness and funds for Motor Neurone Disease (MND). From fundraising events to hands-on involvement, our team has worked hard to make a positive impact and stand alongside those affected by this condition. These efforts reflect our belief that success is not only measured by business growth but also by the difference we make in people's lives.

Our focus remains firmly on enhancing the customer experience: keeping our people and the public safe, making it simpler and faster to work with, and ensuring every hire meets the demands of modern sites efficiently and reliably. In 2026 we plan to introduce new mobile and web functionality to improve the end-to-end hire service from Jarvie Plant Group.

We fully understand that our customers value reliability, flexibility, and genuine service. These principles guide everything we do as we continue to build for the future.

Thank you for choosing Jarvie Plant. We look forward to supporting your success throughout 2026.



CHAIRMAN'S STATEMENT



John Jarvie
Chairman

For over 65 years, Jarvie Plant has exemplified the strength and achievements of a family business rooted in value, trust, and service. What started as a modest local operation repairing essential equipment for local businesses has evolved into a trusted hirer of plant, accommodation & vehicles. Despite our growth, the core spirit of those early days remains integral to our identity.

Across the decades, our journey has been shaped by a simple but powerful belief: that progress comes from continually raising our standards. Whether through investment in modern, high-performance equipment, the training and development of our people, or the strengthening of relationships with customers, partners, and suppliers, we have always looked for ways to deliver more value and more reliability.

The past few years have marked an especially important chapter in our evolution. Our fleet has expanded in both scale and capability, our depot network has been enhanced to improve coverage and responsiveness, and we have placed renewed focus on technologies that support safer worksites, greater efficiency, and improved environmental performance. These advancements are not just operational improvements they represent our commitment to helping customers meet the demands of an industry that is rapidly changing.

None of this would be possible without the exceptional people who represent Jarvie Plant every day. Their expertise, resilience, and dedication are the backbone of our business. From frontline teams to support staff across every division, their contribution ensures we remain a trusted partner to construction, infrastructure, industrial, and public sector organisations throughout the UK.

As we look to the future, our priorities remain clear: responsible growth, continued reinvestment, and a strong focus on long-term sustainability both in our operations and in how we serve our customers. We are preparing the next generation of our family business to grow the company through great service, modern equipment and premises, all while remaining rooted in the values that have guided us for over six decades.

Thank you for taking the time to read this statement. I am confident that the period ahead will bring new opportunities for innovation, collaboration, and continued excellence.

OUR STRUCTURE & LEADERSHIP

Jarvie Plant is proud to remain a family-owned and family-led business, now in its third generation.

Our structure is designed to ensure clarity, accountability and excellent service at every stage of the hire process. At the helm of the business is our Chairman, John Jarvie, supported by David Jarvie, Managing Director, who oversees the day to day operations and strategic direction of the Group.

Our leadership team brings together decades of industry expertise across Plant, Accommodation & Welfare, Power, and Vehicles. Each division is led by specialists who work

closely with our depot teams across Scotland and the North of England to ensure we deliver safe, reliable equipment supported by an experienced and responsive workforce.

With nearly 200 employees working across multiple depots, the business continues to grow through ongoing investment in people, products, sustainability solutions, and modern fleet additions - all underpinned by our commitment to safety, service excellence, and innovation.

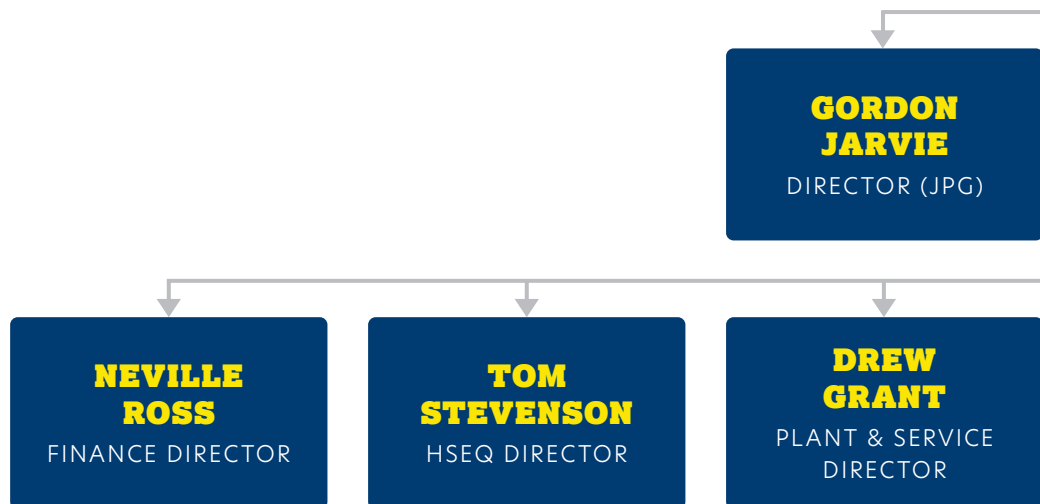



**JOHN
JARVIE**

CHAIRMAN (JPG)

**DAVID
JARVIE**

MANAGING
DIRECTOR (JPG)

**DEBBIE
MCCAFFERTY**

HEAD OF HR

**GARY
JOHNSTONE**

SALES & PLANT
OPERATIONS DIRECTOR

**BRIAN
GALT**

ACCOMMODATION
DIRECTOR

**STUART
GRANTON**

MANAGING
DIRECTOR JPR

JARVIE PLANT DIVISIONS

-  GENERAL & SMALL PLANT
-  SPECIALIST PLANT
-  TELEHANDLERS & ACCESS
-  POWER & LIGHTING
-  ACCOMMODATION
-  WELFARE HIRE
-  VEHICLE HIRE

NAIRN 

ABERDEEN 

DUNDEE 

COWDENBEATH 

GRANGEMOUTH 

PAISLEY 

EDINBURGH 

GLASGOW 

MANCHESTER 

DEPOT LOCATIONS

JARVIE PLANT GROUP

JP RENTALS

VANS

WELFARE VANS

PICK UPS/4X4'S

CARS

MINI BUSES

JARVIE PLANT

TELEHANDLERS/ROTO'S

EXCAVATORS/DUMPERS

ROLLERS/COMPACTION

GENERATORS/FUEL

POWERED ACCESS

SMALL PLANT

JP ACCOMMODATION

HIGH-SECURE

WELFARE

JPX MODULAR

STORAGE

ABOUT US

Jarvie Plant is proud of its modern fleet, constantly investing in the latest technology to provide customers an exemplary service they can trust and rely on.

We have a history of leading the way in the market, having the first telehandlers available for hire in Scotland back in the 80's, to the modern day. Supporting our customers through innovation, reliability and providing

value for money is at the heart of everything we do. Our trained and friendly staff are always happy to help, working with you to select the right equipment to get the job done.

*“ Jarvie Plant offer a reliable, efficient and effective service. All my expectations of a hire company have always been met. ” - **House Builder***



Team members at our New Edinburgh Depot Open Day, where customers explored our latest fleet additions and eco friendly equipment.

OUR MISSION

Provide the highest quality customer service through continued innovation in equipment, delivered safely, efficiently, and sustainably by an inspired and skilled workforce.

OUR VALUES



**SAFETY
CONSCIOUS**



PROGRESSIVE



RESPONSIBLE



COLLABORATIVE



DEPENDABLE



INNOVATIVE SOLUTIONS

We have a large fleet of the most sought after equipment, which allows us to provide the equipment you want when you need it.

Online ordering and Key Account Management

We make hiring equipment easy and efficient through our online ordering service. You can submit your hire details directly through our website and our Hire Desk will quickly generate a tailored quote to suit your project needs. For our key account customers, we go even further. You'll benefit from a dedicated account manager and a Central Service Hub Team who are on hand to process your requests, manage bookings, and handle any account-related queries. We also provide detailed KPI reporting to help you track performance and ensure everything runs smoothly. It's all part of our commitment to delivering reliable service and building strong, long-term partnerships.

We use a digital platform to streamline and modernise our delivery and collection operations. It enables our teams to schedule jobs efficiently using a centralised calendar, assigning tasks to drivers through a simple drag-and-drop interface. Each job is sent directly to the driver's PDA, complete with all necessary documentation, eliminating the need for paper.

Drivers capture real-time proof of delivery, including photos and signatures, while GPS tracking provides full visibility of job progress. The system integrates seamlessly with our internal software, keeping job details and documents in sync. It also helps manage exceptions, such as new site addresses, and offers depot-specific views and live job



status updates - ensuring we maintain high standards of service and operational control.

For your on-site service and repair requirements, please call our friendly and dedicated service team on [0345 208 4444](tel:03452084444) who are on hand and happy to assist.

New Product Investment

We operate a fleet replacement programme to ensure we offer our customers the latest in technological advancements and reassurance in reliability. We are constantly investing in our people and strive for perfection to deliver the unrivalled customer service we are known for.

Dedicated to Providing a Quality Service

At Jarvie we understand there is choice in the market place for our range of products and customers need to know that what they are getting is what they are expecting: Quality Reliable Equipment, suitable for the requirements with an excellent backup service available at competitive market prices. We also pride ourselves in being able to offer the whole range of construction equipment to provide a one call in-house service to our customers.

Our Primary goal is to provide customers with unrivalled quality equipment, technical support and service delivering excellent Value for money.

Quality

We have a fully documented Quality Management System designed to provide our customers with a service that meets their requirements and minimises waste. This is evidenced by our ISO 9001 quality assurance.

We operate a fleet replacement programme to ensure we offer our customers the latest in technological advancements and reassurance in reliability.

Every item of equipment is given a full check both in and out of the depots by our experienced engineers to ensure it conforms to H&S requirements and is fit for use. We keep all records of service and maintenance for every piece of equipment.

Every customer's order is checked to ensure completeness and compatibility of all equipment and accessories supplied. All orders are confirmed by an order acknowledgement to ensure compliance prior to delivery.

Reliability and Back Up Support

Whilst every effort is made to ensure breakdowns do not occur they are an inevitable part of working with machinery. Our fully qualified team of service engineers are trained to handle every product we hire and will ensure downtime is minimised or the item will be exchanged within 24 hours.

Our engineers check major items of plant on a regular basis whilst they are on site. When a service becomes due, an appointment is arranged to carry out the work at a mutually convenient time. Large items of plant are tagged with service hours so that operators can advise us when a service is due.

We aim to have an engineer on site within two hours of your call and a maximum response time of 4 hours. A 24 hour call out service is available if required.

JARVIE
DELIVERS



Jarvie Plant Group

In House Transport Fleet

We operate our own modern fleet of 17 delivery Heavy Goods Vehicles equipped with specialised handling equipment, trailers and fitted with trackers to ensure we can offer guaranteed delivery/collection at competitive rates.

Our transport is managed by our Group Transport Manager to ensure we minimise delivery/collection charges for our customers and ensure equipment is delivered and collected as close to customers requirements as possible.

We have multiple depots throughout Scotland and NW England to better serve our customers needs and offer a competitive transport and maintenance service on our equipment.

Technical Support and Experience

Having established the company in 1960, we have over 50 years experience in the hire industry, meaning we have a highly skilled technical support team available to answer any technical questions about equipment suitability and functionality.

If we don't have it we can source it. We have a wide range of contacts in the hire industry with preferential trade rates who we can re-hire from if we don't have stock.



A DIFFERENT **PERSPECTIVE**

At **Jarvie Plant** we value our staff and seek to provide them with a professional safe and enjoyable work environment.

We are continually looking for innovative ways to train staff, increase communication and improve employee engagement, whilst also motivating our management to work with us to achieve our goals.

Here's what our employees say about us:

“ I actually love the work I do. ”

“ Winning new business still gives me a kick. ”

“ It's stable here, you feel you have job security. ”

“ I have a strong sense of loyalty and feel a sense of achievement in my role! ”

“ I enjoy my work here and the different challenges that we get to deal with. ”

Our customers also play an important role in shaping who we are as a business. In a recent survey we discovered that our core values resonated with our customer's views on the three most important factors when working with a hire company:



QUALITY/RELIABILITY OF EQUIPMENT

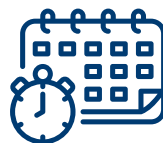

DELIVERY ON AGREED TIME SLOT



AND SPEED OF RESPONSE

We asked our customers about recommending us to another company, and they said:

“ Reliable supplier with a good service reputation and broad range of plant. ”

“ You can pick up the phone and talk to people you know and get results. ”

“ Good people to deal with. ”

“ Extremely satisfied with Jarvie. The best plant hire company in my area by a mile. ”

“ The quality of the kit, the sales manager answering our needs, polite staff. ”



1 PLANNING

- ✓ Planning
- ✓ Planning Approval



2 SITE SET UP

- ✓ Accommodation & vehicles for crew
- ✓ Power & Fuel



- ✓ Landscaping
- ✓ Laying of the final asphalt

6 ROAD FINISHING



LIFE CYCLE OF A CONSTRUCTION SITE

3 GROUNDWORKS

- ✓ Laying Sewers & Services
- ✓ Road Development

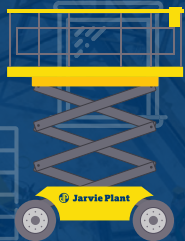

- ✓ Windows & Doors
- ✓ Internal walls & fittings



- ✓ Construction of building(s)
- ✓ Buildings of walls and roofs

CONSTRUCTION

5 FINISHING

4

Jarvie Plant Group can supply equipment, accommodation and vehicles from site start-up through to completion. Event equipment also available.

SUCCESS IN HEALTH & SAFETY

Staff training is key to our success with staff completing specialist training in areas such as, working at height, plant operation, gas safety, first aid, abrasive wheels amongst many others.

With record lows in RIDDORS year on year, Jarvie Plant ensure all accidents and incidents are thoroughly investigated by our experienced managers and appropriate actions taken.

Success in Health and Safety

Jarvie Plant Group is a growing and expanding organisation and the successful operation of the business with employee collaboration is paramount to our current and future success, job security and the development of our company.



ISO Certification

The attainment of ISO 9001:2015 (Quality), ISO 14001:2015 (Environment) and OHSAS 18001:2007 (Occupational Health and Safety Management) and the subsequent 3rd party annual audits to maintain these awards; and also the continuous improvement of Jarvie Plant Group - HSEQ management systems, keeps the

management team and HSEQ Manager busy inspecting and auditing the various depots and departments thus ensuring full compliance with all the aspects of safety, health, environment and the various quality issues in our hire business.

CHAS Accreditation

Jarvie Plant Group has also attained the "Contractors Health & Safety Accreditation Scheme" (CHAS) award which is another measurement of our company H&S success.

Our health and safety standards are as expected very high, this being shown in our accident & incident statistics which show a drop of 50% over 5 years.

Constructionline Membership

As a verified member of Constructionline (Silver Member), Jarvie Plant aligns to industry and government standards. This allows buyers to be confident that Jarvie Plant provides a first class service within plant, accommodation and vehicles to match their requirements.

Health and Safety Management System

Jarvie Plant Group has a very comprehensive health and safety management system which has been accepted and is being applied by all employees from Director to shop floor; this being visible in the diminishing accident record and increased health and safety communications by Managers and Supervisors to their respective employees,

Tom Stevenson, leading our commitment to safe, responsible working practices across all operations



discussing the various health and safety updates and issues thus promoting “Talk Safety and Work Safely”.

Every depot/department is also “3rd party” audited quarterly to ensure full compliance with all the above accreditations.

We continue to demonstrate our commitment and energy in being a leading class when it comes to HSEQ standards.

Site Specific Risk Assessments

Site specific risk assessment and method statements are checked and updated as required prior to issue; generic risk assessments are also part of a quality annual review, thus ensuring that our clients receive our plant and accommodation units in a “safe and effective” manner.

Health and Safety Training

Health and safety training is another valuable attribute to our safety management system; all our management team have completed an IOSH H&S training course - Directors, Managers, Supervisors, employees attend various training packages related to their work task skill - Construction Skills CPCS & CSCS, IPAF, PASMA, SVQ's and various other product related training courses.

At Jarvie Plant Group we have developed a work at height “boxing ring” to allow work at height on the top of accommodation units being overhauled prior to hire, this work being actioned in a very safe manner.

This is only part of the Health and Safety success of the Jarvie Plant Group as we never stop trying to improve our progress to a safer workplace and further development of safe working conditions and practices.



THE ECO-FLEET

2T Electric Excavator

The JCB 19C-1E is a game-changer in the world of compact excavators. Here's why:

- ✓ **Eco-Friendly:** Zero emissions make it perfect for indoor and urban projects.
- ✓ **Whisper Quiet:** Super low noise levels, ideal for sensitive areas.
- ✓ **All-Day Power:** Four lithium-ion batteries keep it running all day on a single charge.
- ✓ **Cost-Effective:** Less maintenance means more savings.
- ✓ **Safe and Smart:** The 2GO system and other features ensure safe operation.

Manitou MRT2660E Oxygen

A cutting-edge, 100% electric or hybrid rotating telehandler engineered for high-performance lifting with zero emissions and exceptional versatility.

- ✓ **Zero Emissions & Low Noise** – Ideal for environmentally sensitive and urban job sites.
- ✓ **Impressive Lifting Capabilities** – Designed for demanding lifting operations with precision and power.
- ✓ **360° Rotating Turret** – Offers full rotational flexibility for maximum efficiency.
- ✓ **Advanced Lithium-Ion Battery System** – Ensures long-lasting, reliable energy performance.
- ✓ **Hybrid Flexibility** – Switch seamlessly between electric and hybrid modes to suit your operational needs.

Solar Welfare Units

- ✓ **Solar-Powered with Battery Backup** – Provides silent, eco-friendly operation for lighting and heating without needing the generator.
- ✓ **Fully Self-Contained Facilities** – Includes seating, microwave, kettle, hot water, chemical toilet, drying room, and HSE-compliant hot wash station.
- ✓ **High Security Design** – Steel body shell, lockable cowling, and secure doors/windows for safe site use.
- ✓ **Flexible Power Options** – Solar charging with battery pack, plus diesel generator for high-demand appliances like kettles and microwaves.
- ✓ **Ideal for Remote Sites** – Ground-lowering chassis and towable design make it easy to deploy in hard-to-reach locations.

Electric Vans

- ✓ **Zero Emissions & Low Noise** – Ideal for urban deliveries, site transport, and environmentally sensitive areas.
- ✓ **Up to 3.5T GVW Capacity** – Suitable for transporting goods, tools, and equipment efficiently.
- ✓ **Flexible Hire Options** – Available for short or long-term rental across Scotland and NW England, with delivery available.
- ✓ **Modern, Reliable Fleet** – Maintained to high standards for safety, comfort, and performance.
- ✓ **Supports ESG Goals** – Helps businesses reduce carbon footprint and meet sustainability targets.



JCB 1TE Electric Dumper

- ✓ **100% Electric & Zero Emissions** – Perfect for indoor, urban, and environmentally sensitive sites.
- ✓ **Low Noise Operation** – Enables night work and improves on-site communication.
- ✓ **All-Day Battery Life** – Powered by dual 48V lithium-ion batteries with rapid 110V/230V charging options.
- ✓ **High Tip Skip** – Easily tips into skips and containers, ideal for confined or elevated discharge areas.
- ✓ **Built Tough** – All-steel body, ROPS frame, and components shared with diesel models for durability and safety.

JCB 525-60E 6m Electric Telehandler

- ✓ **100% Electric & Zero Emissions** – Ideal for indoor, urban, and eco-sensitive environments.
- ✓ **2,500kg Lift Capacity & 6m Reach** – Delivers strong performance with no compromise compared to diesel models.
- ✓ **Up to 8 Hours Runtime** – High-capacity lithium-ion battery supports full-day operation on a single charge.
- ✓ **Compact & Manoeuvrable** – Narrow width (1.84m), low height (1.89m), and tight turning radius for confined spaces.
- ✓ **Quiet Operation & Enhanced Safety** – Low noise levels and Hi-Viz chassis improve site safety and comfort.

ST-9 (LED-4) Solar-Only Lighting Tower

- ✓ **LED Lighting:** 4 x 100W adjustable LED lights.
- ✓ **Solar Power:** 1440W high-efficiency solar panels.
- ✓ **Battery Storage:** Heavy-duty, deep-cycle batteries.
- ✓ **Zero Emissions:** No CO² emissions or fuel usage.
- ✓ **Mobility:** 9-meter vertical mast, easy transport and setup.
- ✓ **Durability:** Vandal and shatter-proof solar panels.

Husshpods

Hussh Pod generators are cutting-edge, eco-friendly power solutions. They combine lithium-ion batteries with renewable energy or diesel, offering:

- ✓ **Whisper-quiet operation for noise-sensitive areas.**
- ✓ **Eco-friendly with reduced emissions.**
- ✓ **Versatile use for construction sites, telecoms, and more.**

Perfect for when you need reliable, green power without the noise!



TRANSPORT

Jarvie Plant Transport Solutions/Tractor Unit & Crane Mounted Truck Hire

At JP Transport solutions we operate a fleet of over 20 Heavy Goods Vehicles, all of which are fitted with Telematic Tracking Devices.

Driving behaviour is also monitored daily ensuring we get the optimum miles per gallon, assisting to reduce your cost & carbon footprint.

Our fleet of 8x2 (32t GVW) rigid vehicles are fitted with market leading Fassi and Pal-finger cranes with lifting capacity of up to 82t/m.

We also operate (44t GVW) tractor units with various flatbed and step frame trailer options. All our Driver/Operators are Trained, Certified & Experienced in accordance with their specific vehicle requirement.

As an Affiliated member of UK Logistics (FTA) we ensure that our Transport Operations are always up to date with current Transport Legislation and Regulations.

If you would like to place a booking, ask advice or gain more information on our Transport Services available, please call 01324 496500 and talk to our dedicated Transport Team.

Jarvie Plant is introducing **CameraMatics systems** to their HGV fleet to enhance safety, compliance, and operational efficiency.

360° Camera Coverage

External and internal cameras provide full visibility around the vehicle, including blind spots, cargo areas, and rear views.

DVS25 Compliance

Meets the updated Direct Vision Standard (DVS) requirements for operating HGVs in Greater London from May 2025, helping avoid fines and restrictions.

Driver Monitoring & Safety Alerts

Detects fatigue, distraction, and risky behaviours like phone use or smoking, with in-cab alerts to improve driver performance.

AI-Powered Pedestrian Detection

Identifies vulnerable road users (pedestrians and cyclists) around the vehicle and alerts the driver in real time, reducing accident risk.

Insurance & Incident Protection

HD video evidence supports faster claims processing, protects against fraudulent claims, and helps exonerate drivers.



ACCESS PLATFORMS

Our range of diesel, rough terrain, 4WD 4WS, articulated Manitou boom platforms are available from 16m to 20m. We also offer a range of manual platforms and electric scissor lifts up to 12m (working height).

These compact electric scissor lifts offer a stable platform at working heights of up to 12m. Should you need to reach heights in tight spaces these are the platforms you need. Our electric scissor lifts feature longer run time, higher productivity. The energy efficient direct electric drive boosts your productivity. The electric motor gives you

a quieter work area, less dependency on hydraulic oils, and zero emissions. These platforms can traverse grades of up to 25%, have compact dimensions so they can travel through doorways and a easily accessible battery storage with no drawers to pull out.

✓ Rugged all-terrain ✓ Easy to operate ✓ Extendable platform to allow larger working area at height

MANUAL LIFT / ELECTRIC SCISSOR

CODE	SCRE080	SCRE120	SCRE160
Description	Electric Scissor	Electric Scissor Lift	High-reach, zero-emission electric scissor
Model	JCBS3246E Electric Scissor Lift	JLG 10RS Electric Scissor Lift	JCB S4550E
Length (mm)	2,070	2,410	2,760
Width (mm)	810	1,220	1,250
Height (mm)	1,000 (Lowered)	1,380 (Lowered)	2,600
Max Working Height (m)	8	12	15.5
Max Platform Height (m)	5.79	9.75	13.8
Capacity (kg)	230	320	705

Our range of articulated booms reaches working heights of up to 20m. Ideal for structural works, finishings and fittings, cleaning, sanding, pruning, and maintenance within ports, airports and events operations.

The all-terrain feature allows the machine to traverse slopes up to 40%. Its on-screen showing real-time fuel levels, hour meter and battery voltage.

✓ Rugged all-terrain ✓ 4 wheel drive and 4 wheel steer ✓ 360 turret rotation

ACCESS PLATFORMS

CODE	HIWPR120	HIWPR170	HIWPR170H	HIWPR180	HIWPR200	HIWPR100V
Description	Access Platforms	Access Platforms	Electric Hybrid Electric Platform	Access Platforms	Access Platforms	Access Platforms
Model	MAN'GO 12	Manitou 160ATJ/JLG 250ATJ	A45EH	Manitou 180ATJ	Manitou 200ATJ	Manitou 100VJR S/G HIWPR100V
Operating Length (mm)	5,500	7,025	7,040	7,770	8,500	2,800
Width (mm)	1,800	2,300	2,260	2,300	2,400	990
Max Working Height (m)	11.91	16.01	15.84	17.65	20	9.85
Max Platform Height (m)	9.91	14.01	13.84	15.65	18	7.90
Max Outreach (m)	6.69	8.3	7.48	10.6	12	3.10
Basket Capacity (kg)	230	230	300	230	230	200
Turning Radius with Basket (m)	4.1	5.94	4.67	6.87	7.45	2,020

HIWPR100V
Work Platform



SCRE080
Electric Scissor



SCRE120
Electric Scissor



HIWPR120
Work Platform



HIWPR180
Access Platform



HIWPR200
Access Platform



DUMPERS

Our wide fleet ranges from 500kg capacity tracked barrows (indispensable on restricted sites and smaller projects, like driveways, paths, patios and conservatories) right up to 11 tonne load capacity cabbed dumpers (ideal for larger projects). Multifunctional, robust and agile, our tracked dumpers ensure low ground pressure, are highly manoeuvrable and offer excellent all-round performance. Our cabbed dumpers, as well as protecting the operator from falling debris, the two-door level II ROP/FOPS gives added protection. If your site is susceptible to the elements, our cabbed dumper maintains productivity by keeping the operator comfortable and able to work.

“ Jarvie have been our main supplier now for several years, investing heavily to support our needs across Great Britain. Our teams have built a collaborative relationship across multiple functions including sales, service and operations ensuring our plant and vehicle expectations and service are always delivered. ” - Material Producer

The applications required of site dumpers today are vast. Our fleet has grown to a specialised level, offering the market and its disciplines a range that includes Standard, Power-swivel, Hi-tip to 10 ton capacities - all 4 wheel drive. Our tracked dumper fleet ,

for applications on unstable ground or steeper gradients includes capacities from the small pedestrian 'tracked barrows' to 6.5 ton. With many sizes, there is a machine to suit most applications.

WHEELED DUMPERS

CODE	DUMH1000	DUMS3000	DUM6000/ DUM6000L	DUMS6000/ DUMS6000L
Description	1 Tonne Hi-Tip	3 Tonne Swivel	6 Tonne Straight Tip	6 Tonne Swivel
Model	Neuson 1001	Thwaites 3T	JCB 6T	JCB 6TFT
Length (mm)	3,080	3,952	4,408	4,539
Width (mm)	1,180	1,846	2,240	2,207
Height (mm)	2,580 (with ROPS)	2,920 (with ROPS)	3,470 (with ROPS)	3,203 (with ROPS)
Weight (kg)	1,215	2,330	4,325	4,410
Max Payload (kg)	1,000	3,000	6,000	6,000
Skip Capacity Heaped (L)	525	1,880	3,400	3,530

WHEELED DUMPERS

CODE	DUM9000L	DUMS9000	DUMS9000C	DUM9990	DUM9993
Description	9 Tonne Straight Tip	9 Tonne Swivel	9 Tonne Swivel Cabbed	10 Tonne Straight Tip	10 Tonne Cabbed
Model	Wacker Newuson 9001	Thwaites 9T/PS	Neuson WN90	Thwaites 9T	Neuson DW90
Length (mm)	4,560	5,011	4,560	4,650	4,560
Width (mm)	2,420	2,440	2,420	2,440	2,420
Height (mm)	3,130 (with ROPS)	3,415 (with ROPS)	3,070 (with ROPS)	3,415 (with ROPS)	3,070 (with ROPS)
Weight (kg)	4,770	5,360	5,050	4,710	5,050
Max Payload (kg)	9,000	9,000	9,000	10,000	10,010
Skip Capacity Heaped (L)	4,700	4,250	4,700	4,700	4,850

ACCESSORIES - We offer a range of accessories to compliment our dumpers.

CODE	DUMX1000	DUMG-GT	HFR-01	DUMX1000
Description	Road Tax Lighting Kit	Grass Tyres	HFR	VCAS
Note	Lighting kits and tax are available on all our wheeled dumper range	Grass tyres available on 6 & 9 Tonne Dumpers	Human Form Recognition Camera System	Vehicle Collision Avoidance System available on all 6 & 9 Ton Dumpers. Forward Facing Cameras available on all Dumpers



Tracked Carriers / Dumpers

We offer one of the widest ranges of tracked carriers only stocking quality brands such as Morooka and Yanmar. These carriers are usually found working in remote areas where ground conditions are soft and unstable. We can mount these machines with compressors.

TRACKED DUMPERS

CODE	DUMT0650	DUMT2500S	DUMT2500	DUMT4000	DUMT4000S
Description	Hi-Tip Tracked Barrow	3.0T Swivel Skip Tracked Dumper	4.0 Tonne Tracked Dumper	7.5 Tonne Tracked Dumper	9 Tonne Tracked Dumper
Model	JCB HTD5	Yanmar C30R-3TV	Yanmar C30R	Morooka MST600	Yanmar C50R-5ATV
Length (mm)	1,700	2,793	3,200	3,970	4,540
Width (mm)	690	1,270	1,655	2,040	2,000
Height (mm)	1,100 (Transport Position)	2,370	2,255	2,270	2,680
Weight (kg)	475	1,330	2,290	4,000	5,125
Max Payload (kg)	500	1,700	2,500	3,500	3,800
Gradeability	25	30	30	30	30
Ground Pressure (kg/cm ²)	0.35	0.15	0.16	0.17	0.17
Ground Pressure Full (kg/cm ²)	0.79	0.37	0.54	0.26	0.31

**DUMT2500S****DUMT4000S****DUMT7000****DUMT7000S**

Durable rubber tracks offer the traction of a steel-tracked dumper but with low ground pressure and great traction. The innovative undercarriage design allows the machine

to be in constant contact with the ground, absorbing the impacts of uneven surfaces.

TRACKED DUMPERS

CODE	DUMT5000	DUMT7000	DUMT7000S
Description	6.5 Tonne Straight Tip Tracked	11 Tonne Straight Tip Tracked	Fully rotating rubber-tracked dumper/carrier
Model	Morooka MST800	Morooka MST1500VD	MST1500VDR
Length (mm)	4,430	5,300	5,638
Width (mm)	2,470	2,640	2,590
Height (mm)	2,590	2,900	8,000
Weight (kg)	6,500	9,200	27%
Max Payload (kg)	4,300	6,300	0.302
Gradeability	30°	30°	0.465
Ground Pressure (kg/cm ²)	0.17	0.17	0.17
Ground Pressure Full (kg/cm ²)	0.28	0.28	0.28



HYDREMA 912F 12T



BELL B30E

ARTICULATED DUMP TRUCKS

	Hydrema 912F 12T Articulated Dump Truck (ADT)	Hydrema 922G 20T Articulated Dump Truck (ADT)	Bell B30E 30T Articulated Dump Truck (ADT)
Model	Hydrema 912F	Hydrema 922G	Bell B30E
Length (mm)	5,950	9,200	9,953
Width (mm)	2,490	2,550	3,268
Height (mm)	2,750	3,300	3,426
Weight (kg)	7,730	14,000	22,885
Max Payload (kg)	10,000	20,000	28,000
Gradeability	Up to 40° unloaded, 32° loaded depending on slope direction	35°	35°
Ground Pressure (kg/cm ²)	0.87	0.26	1.37
Ground Pressure Full (kg/cm ²)	1.33	0.49	2.45



EXCAVATORS

Whether you are landscaping, carrying out utility work, demolishing a building or even constructing a building we have an excavator to suit your needs. We have seen the popularity rise for self-drive excavators in many of the housing, construction and civil engineering sectors. Our large investment in this area is a true reflection of the capability and versatility of this type of plant.

Add Operated Hire for Complete Peace of Mind
Our excavators and rotating telehandlers are available with fully trained, certified operators as an optional add-on service. This means you get the right machine and the right expertise on site - reducing downtime, increasing productivity, and ensuring safe, efficient operation from the moment the equipment arrives.

Mini Excavators

Our mini fleet ranges from an 800kg Micro that is narrow enough to fit through a standard door width to 8.5 tonne. With a wide variety of attachments makes our machines versatile for all your site needs. Some key features are:

✓ 'Zero Tail Swing' ✓ Fully automatic quick hitches ✓ Kitted for hydraulic breakers

MINI EXCAVATORS

CODE	EXC1000	EXC1500	EXC1600	EXC2500	EXC2700
Description	800KG Micro Excavator c/w Rops	1.5 Tonne Mini Excavator	1.6 Tonne Mini Excavator	2 Tonne Mini-Electric	3 Tonne Cabbed Mini Excavator, Kubota KX027-4
Model	Kubota K008-5	Kubota KX015	Wacker Neuson ET16	JCB 19C	Kubota KX027-4
Length (mm)	2,980	3,710	3,710	4,190	4,370
Width (mm)	750/990	990	990/1,240	1,500	1,400
Height (mm)	2,230	2,350	2,350	2,430	2,420
Weight (kg)	990	1,545	1,615	2,665	2,590
Max. Digging Force Arm (kN)	5.4	7.3	7.3	12.3	12.9
Max. Digging Force Bucket k(N)	10.4	12.7	12.7	21	22.1
Max. Digging Reach (mm)	3,330	3,730	3,130	4,630	4,720
Max. Digging Depth (mm)	1,800	2,250	2,250	2,820	2,740

Midi Excavators

All our comprehensive range of excavators come with a set of three buckets including a ditching as standard.

MIDI EXCAVATORS

CODE	EXC4800Z	EXC8200	EXC8500
Description	5 Tonne Excavator Zero Tail	8.2 Tonne Midi Excavator	8.5 Tonne Midi Excavator
Model	Kubota U50-5	Kubota KX080-4	CAT 308CR/ Kubota KX085-5
Length (mm)	5,355	6,450	6,656/6,450
Width (mm)	1,960	2,200	2,300/2,200
Weight (kg)	4,965	8,270	8,728/8,465
Max. Digging Force Arm (kN)	22.6	38.1	35.7/38.1
Max. Digging Force Bucket k(N)	32.8	65.2	62/65.2
Max. Digging Reach (mm)	5705	7,170	7,460/7,300
Max. Digging Depth (mm)	33.70	4,600	4,643/4,600



**3T Cabbed Mini Excavator,
Kubota - KX027-4
EXC2700**

ACCESSORIES

	Height & Slew	LGP Tracks
Model	Height and Slew Parameter Restriction	900mm Steel Tracks for Low Ground Pressure Applications



**5T Zero Tailswing Cabbed Mini
Excavator, Kubota - U50-5
EXC4800Z**



LARGE EXCAVATORS

Our fleet of large excavators are suited to digging large trenches and demolition work. With machines from 10 tonnes up to 22 tonnes we have what you need.

Some key features of our excavators are:

- ✓ Quick hitch for attachments
- ✓ Ergonomic and easy to use operator controls
- ✓ Kitted for hydraulic breakers
- ✓ We also offer machinery with height and slew restrictors

LARGE EXCAVATORS

CODE	EXCD-014	EXCD-014Z	EXCD-016	EXCD-20C
	13/14 Tonne - Tracked Excavator c/w Boxing Ring, Rear Camera and Shutter Kit	14 Tonne - Reduced Tailswing c/w Boxing Ring, Rear Camera and Shutter Kit	15/16Tonne - Tracked Excavator c/w Boxing Ring, Rear Camera and Shutter Kit	20/22 Tonne - Tracked Excavator c/w Boxing Ring, Rear Camera and Shutter Kit
Manufacturer	JCB	JCB/KOBELCO	JCB	JCB/CAT
Model	131X/140X	145XR/SK140SRLC-7	150X	220X/320GC
Length (mm)	7,659	7,610	7,700	-
Width (mm)	2,590	2,840	2,880	2,990
Height (mm)	2,866	3,195	2,900	2,698
Weight (kg)	15,275	18,870	16,000	22,000
Max. Digging Force Arm k(N)	65-70	-	-	-
Max. Digging Force Bucket k(N)	100	104.5	-	-
Mac Digging Reach (mm)	9,000	9,230	-	9,624
Max. Digging Depth (mm)	6,160	6,167	6,200	6,460

“Extremely satisfied with Jarvie. The best plant hire company in my area by a mile.”

- Landscaping Company

JCB BACKHOE LOADERS

Our range of Backhoe Loaders are highly versatile machines with quickhitch which saves time when you need to change attachments. Their compact designs makes them ideal for working in tight spaces.



JCB 3CX Backhoe Loader
EXC9-040

BACKHOE LOADERS / 180 EXCAVATORS

CODE	EXC9-035	EXC9-040
Description	6 Tonne 55kw Backhoe Loader c/w 12' Extending Dipper, Hydraulic PTO with Hose Reel & 4-IN-1 Shovel	8 Tonne 81kw Backhoe Loader c/w 6-in-1 Shovel
Manufacturer	JCB	JCB
Model	3CX Compact	3CX Plus
Length (mm)	5,540	5,620
Width (mm)	2,000	2,350
Height (mm)	2,740	3,610
Weight (kg)	6,070	8,600
Max Digging Reach (mm)	3,990	6,520
Max. Digging Depth (mm)	3,720	5,460



Develon DX100W-7
EXCD-11W



JCB 160 Wheeled Excavator
EXCD-16W

WHEELED EXCAVATORS

CODE	EXCD-11W	EXCD-16W
Description	10/11 Tonne Wheeled Excavator, TAB Boom, Blade & Stabilisers	16/17 Tonne Wheeled Excavator, Mono Boom, Blade, Stabilizers & HFR
Manufacturer	Develon	JCB
Model	DX100W-7	JS160W
Length (mm)	6,700	8,275
Width (mm)	2,700	2,498
Height (mm)	3,000	3,195
Weight (kg)	11,440	18,982
Max. Digging Force Arm k(N)	58.6	99
Max. Digging Force Bucket k(N)	58.6	102
Max Digging Reach (mm)	8,000	8,455
Max. Digging Depth (mm)	4,245	9,275

EXCAVATOR

HYDRAULIC BREAKERS

We carry a wide selection of accessories, including hydraulic breakers and buckets such as:

- ✓ Trapezoidal
- ✓ Processing buckets
- ✓ Window Shutters
- ✓ Vibrating plates on our larger excavators

HYDRAULIC BREAKERS

We have a wide range of hydraulic breakers for each of our machines to suit your needs. If you don't see the size of breaker you need just ask.

CODE	Excavator Size
EXCX-010	700kg < 1,000kg
EXCX-011	1.5 Tonne < 2.0 Tonne
EXCX-012	2.5 Tonne < 3.2 Tonne
EXCX-013	3.5 Tonne < 6.0 Tonne
EXCX-014	8.0 Tonne < 11.0 Tonne
EXCX-015	13.0 Tonne < 15.0 Tonne
EXCX-016	16.0 Tonne < 22.0 Tonne



EXCAVATOR ACCESSORIES

- Hydraulic Breakers
- Pallet Forks Attachments
- Hydraulic Grabs & Grapples
- Compactor Plates
- Hydraulic Grabs & Grapples
- Tilting Ditching Buckets
- 180 Degree Powertilt Attachments
- Tilt Rotator Attachments
- Ripper Teeth
- Special Buckets - Trapezoidal, Fibre, Riddle, Screening, Concrete





TELEHANDLERS & FORKLIFTS

Jarvie Plant have been hirers of this equipment for over 40 years. Our proven track record and expertise is focused on the various markets which utilise them and is unsurpassed. Listening to our customers has led us to develop a consistent product, offering service and production support that adds value to our customers business.

FORKLIFTS

Industrial fork trucks are machines that fulfil all your needs, thanks to the numerous options and attachments that you can adapt according to your application. Whatever the load type and operating frequency, you will find the solution at Jarvie Plant. Our forklift trucks are equipped with monobloc chassis, and have strengthened masts and axles. The machines are fitted as standard with an air filter consisting of a primary filter and a security cartridge and are designed to resist corrosion and vibration. To meet your height requirements, we offer a number of mast options:

DUPLEX Two mast sections one fixed, one sliding. The sliding section is activated when the operator uses the hydraulic lever.

FREE LIFT DUPLEX The central cylinder gives the operator greater free lift without having to raise the mast.

TRIPLEX FREE LIFT The central cylinder gives the operator greater free lift without having to raise the mast. The mast consists of three sections, which allow for a low overall height while maintaining a significant working height.

Grass tyres to suit are available for Event hire requirements.

FORKLIFTS

CODE	FLTID2500	FLTM2600	FLTID2500G	FLTID3000
Description	2.0 Tonne - 2.5 Tonne C/Balance Forktruck Electric/Diesel	2.6 Tonne Masted Forklift	2.5 Tonne C/Balance Forktruck	2.5 Tonne C/Balance Forktruck
Model	Manitou ME420 & Mi25D	Manitou M30-4	Manitou Mi25G	Manitou Mi30D
Length (mm) Fork Included	3,685	4,740	3,683	4,740
Width (mm)	1,160	1,920	1,143	1,920
Height (mm)	2,190	2,730	2,108	2,720
Capacity (tonne)	2.5	2.6	2.5	3
Lift Height (mm)	4,700	5,400	6,502	5,400



FLTID2500
Manitou ME420 & Mi25D



FLTID2500G
Manitou Mi25G



FLTID3000
Manitou Mi30D

Our Extensive Telehandler Range from 4m lift height up to 20m Lift Height provides the solution for all your Site or Warehousing Requirements. With superb traction, manoeuvrability and Fuel Efficient Environmentally Friendly Engines you will get the task at hand done Safely, Efficiently and Economically.



TELEHANDLERS

CODE	FLTT004J	FLTT006A	FLTT007	FLTT009
Description	4m Compact Tele 2.0 Tonne Max Capacity	6m Compact Tele 2.5 Tonne Max Capacity	7m Telehandler 3.1 Tonne Max Capacity	9m Telehandler 3.5 Tonne Max Capacity
Manufacturer	Manitou/JCB	Manitou/JCB	JCB	JCB
Model	MT420/520-40	MT625/525-60	531-70	535-95
Length (mm) to Carriage	3,640/3,380	3,900/4,000	4,990	4,990
Width (mm)	1,490/1,560	1,810/1,840	2,230	2,360
Height (mm)	1,970/1,970	1,920/1,890	2,490	2,490
Capacity KG	2,000/2,000	2,500/2,500	3,100	3,500
Max Lift Height Mtrs (Forks)	4.35/4.03	5.85/6	7	9.5



- ✓ Great visibility and complete safety
- ✓ Easy to operate
- ✓ Excellent manoeuvrability

TELEHANDLERS

CODE	FLTT012	FLTT014M	FLTT018M	FLTT020
Description	12m Telehandler 3.5 Tonne Max Capacity	14m Telehandler 4.0 Tonne Max Capacity	18m Telehandler 4.0 Tonne Max Capacity	18m Telehandler 4.0 Tonne Max Capacity
Manufacturer	JCB	Manitou/JCB	Manitou/JCB	JCB
Model	535-125	MT1440/540-140	MT1840/540-180	540-200
Length (mm) to Carriage	5,800	6,130/6,230	6,270/6,270	6,810
Width (mm)	2,350	2,360/2,350	2,360/2,350	2,440
Height (mm)	2,590	2,450/2,590	2,450/2,590	2,720
Capacity KG	3,500	4,000/4,000	4,000/4,000	4,000
Max Lift Height Mtrs (Forks)	11.7	13.53/12.9	17.55/17.5	20

Proud Creative Partner
of Jarvie Group.

altar



Build. Together.

We work side by side with you, bringing everything together to help you get noticed, bring in more work and grow your business. Get in touch today.

*Inspire,
create,
repeat*

Branding | Design | Websites | Exhibitions | Digital Marketing

01382 427000 info@altar.agency

altar.agency



WHY CHOOSE **JARVIE PLANT** FOR ALL YOUR HIRE NEEDS

This case study highlights the benefits of using Jarvie Plant for all your hire needs, including plant, telehandlers, rotos, power, accommodation and vehicles. The client prefers Jarvie Plant for accommodation, telehandlers and power for several compelling reasons.

Key Benefits:

- ✓ **Single Supplier Convenience:** Dealing with one company simplifies the process, eliminating the hassle of coordinating with multiple suppliers.
- ✓ **High-Quality Equipment:** Jarvie Plant provides top-notch equipment, particularly their accommodation units, which stand out for their quality.
- ✓ **Dedicated Support:** The account manager ensures that all accommodation needs are met efficiently, providing personalised and reliable service.
- ✓ **Commitment to Clients:** Jarvie Plant's willingness to commit telehandlers to the client, a service unmatched by other companies, demonstrates their dedication.
- ✓ **Streamlined Communication:** Having a single point of contact for account issues, with both the client and the account manager involved, makes planning and problem-solving straightforward.
- ✓ **Efficiency and Simplicity:** Jarvie Plant's services make the client's job easier and more straightforward, saving valuable time.
- ✓ **Responsive Service Team:** The service team's quick response times ensure that issues are resolved promptly.
- ✓ **Accurate Invoicing:** Invoices are always correct, eliminating the need for the client to query or dispute charges.

By choosing Jarvie Plant, the client enjoys a seamless, efficient, and reliable hiring experience, **making their operations smoother and more productive.**

TELEHANDLERS ATTACHMENTS

We offer a wide range of attachments for our telehandlers allowing them to be more versatile.

Included in our range are collector brushes for cleaning your site, block grabs to move pallets, extension forks to give you better reach. If you need to get your workers up high we offer a 2 man cage attachment. For inclement weather why not hire our snow plough attachment to clear your site.

CODE	FLTXEXTF	FLTXBRUSH	FLTXBUC	FLTXHOOK	FLTXBG
Description	We have a range of Fork Extension Sleeves for Safe Handling of Kit Panels etc ranging from 500kg Capacity per pair up to 2000kg Capacity per Pair.	Powerbrush Forklift Sweeper cleans and collects dirt and waste. With 250ltr Water System to keep your site Clean.	General Purpose Buckets available across our Telehandler Range, Hard Wearing with Reversible Cutting Edges.	Fork Hooks are available for our Telehandler Range from 4 Tonne to 5 Tonne, Heel Pin Secured for Safety with swivel Safety Hooks.	Mechanical Block Grabs (Supplied with Fork Hook) are available with 1.5 Tonne and 1.8 Tonne Capacity to meet your block/brick handling needs.

CODE	FLTXALTS	FLTXMORSKIP	FLTXRTH-M	FLTXRTH-J
Description	Our Autolock Tipping Skip provides a safe, and efficient solution for the handling of general waste on construction sites. These are also available Colour Coded as per the Considerate Contractor Scheme Best Practice.	Our 250ltr Mortar Skips are Heavy Duty and designed to Safely secure and lift Mortar with your Telehandler, having both Fork Pockets and Lifting Points these are Safer, more robust and long lasting than standard plastic Tubs.	Our Extendable Manitou Roof Truss Handlers give a Safe and efficient solution to Installing Roof Trusses without the requirement of a Crane. CAPACITY 600kg @ 4m 300kg @ 5m 100kg @ 6m	Our Extendable JCB Roof Truss Handlers give a Safe and efficient solution to Installing Roof Trusses without the requirement of a Crane. CAPACITY 300kg @ 4m 150kg @ 6m



FLXEXTF
Kit Panel Extension Forks

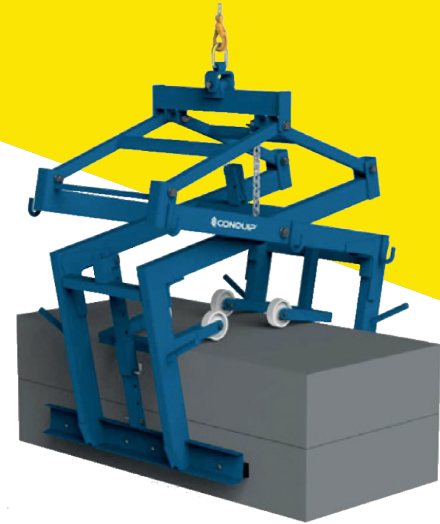

FLTXBG
Block Grab with Fork Hook



FLTXBRUSH
Powerbrush Forklift Sweeper



FLXMORSKIP
250ltr Mortar Skip



ROTATING TELEHANDLERS

The market for Roto's has grown with a need for versatile machines and the increasing number of sites with restricted access. Our offering of Rotary Machines has increased to 30 Metre and 7 Tonne. All our roto's can be hired with a variety of attachments to suit your needs.



Site Surveys
on Request



3-in-1
Machine

ROTATING TELEHANDLERS

CODE	FLTR025-5	FLTR026-5	FLTR026-6	FLTR026-6E
Description	25m Roto 5 Tonne Max Capacity	26m Roto 5 Tonne Max Capacity	26m Roto 6 Tonne Max Capacity	26m Hybrid/Electric Roto 6 Tonne Max Cap
Manufacturer	Manitou	Merlo	Manitou	Manitou
Model	MRT2550 Priv Plus	50.26 S-Plus	MRT2660 Vision Plus	MRT2660E Vision Plus
Length to Coupler (mm)	6,870	7,150	8,080	8,080
Width (mm)	2,490	2,430	2,500	2,500
Height (mm)	3,050	3,120	3,100	3,100
Capacity KG	4,999	4,950	5,000	5,000
Max Lift Height Mtrs (Forks)	24.7	25.9	25.9	25.9

CODE	FLTR030-5	FLTR030-6	FLTR035-7
Description	30m Roto 5 Tonne Max Capacity	30m Roto 6 Tonne Max Capacity	35m Roto 7 Tonne Max Capacity
Manufacturer	Manitou/Merlo	Manitou	Manitou
Model	MRT3050/50.30 S-Pus	MRT3060 Vision Plus	MRT3570 Vision Plus
Length to Coupler (mm)	7,820/7,790	7,940	8,860
Width (mm)	2,490/2,490	2,500	2,500
Height (mm)	3,050/3,160	3,100	3,260
Capacity KG	4,999/4,950	6,000	7,000
Max Lift Height Mtrs (Forks)	29.7/29.2	29.9	34.7

CASE STUDY

LONG TERM PARTNERSHIP WITH JARVIE PLANT

Background:

We have utilised the services of Jarvie Plant for over 30 years, relying on them for the supply of telehandlers, roto machines, and office/welfare facilities. This long-standing relationship underscores our trust and satisfaction with their services throughout our time in the house building sector.

Experience:

We have never sought services from another supplier, which speaks volumes about our loyalty and confidence in Jarvie Plant.

Key aspects of our experience include:

- **Professionalism:** Jarvie Plant is consistently described as “professionally run,” indicating a high standard of service and operational efficiency.
- **Ease of Communication:** We find Jarvie Plant “very easy to deal with,” reflecting their customer-centric approach that prioritises clear and effective communication.

Future Outlook:

We look forward to continuing our partnership with Jarvie Plant for as long as we remain in the house building sector. This positive sentiment highlights the value of long-term relationships in business, especially in industries where reliability and quality are essential.

Conclusion:

Our experience with Jarvie Plant exemplifies the importance of trust and satisfaction in supplier relationships. Their commitment to professionalism and customer service has fostered a lasting partnership, demonstrating that quality service can lead to decades of loyalty.



ROTATIONAL **TELEHANDLER** ACCESSORIES

- Long Forks - Programmed to Machine
- Personnel Platforms - 365kg up to 1,000kg (Fixed and variable width)
- 3D Articulated Platforms
- Direct Mount Lifting Hooks 5 Tonne < 7 Tonne
- Hydraulic Winches - 3 Tonne < 7 Tonne Capacity
- Jib Winches- Fixed and Adjustable Length <2,000kg Capacity
- Crane Forks for safely placing Pallets
- Concrete Twinflow Crane Skip - 750ltr
- Concrete Upright Crabe Skip - 1,000ltr

Add Operated Hire for Complete Peace of Mind

Our excavators and rotating telehandlers are available with fully trained, certified operators as an optional add-on service. This means you get the right machine and the right expertise on site - reducing downtime, increasing productivity, and ensuring safe, efficient operation from the moment the equipment arrives.

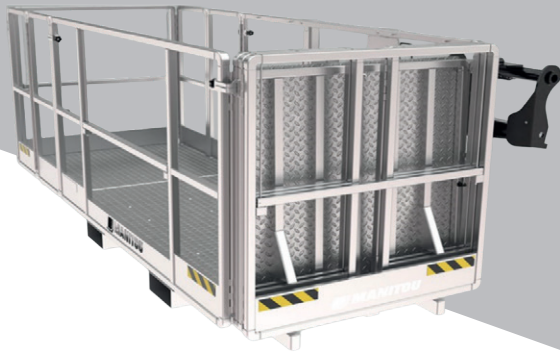

365KG Personnel Cage
(Extendable)



3D Roto Platform



Winches -
3 Tonne up to 7 Tonne



Variety of Winch Jibs
for any application



ROLLERS

The construction or reinstatement of pathways, roads, motorways or excavations requires different types of compaction. We have a full range of vibratory equipment for most types of compaction on most applications.

With one of the largest compaction ranges in the UK we work with a number of council, civils and road surfacing contractors.

We offer 28" Single drum rollers to 16 Tonne Self-Propelled rollers with padfoot option.

If you have a tight space on site that sits on difficult soil that has a risk of overturning then our Bomag BMP8500 is the roller for you. The roller can be operated from 1 to 2 metres away keeping your operator safe.

For those large road surfacing projects our Hamm HW90B Tricycle roller is the ideal machine. With ideal load distribution between the front and rear drums this roller can compact large areas of asphalt. The large 400 litre water tank allows you to work for longer periods.



ROLLERS

	ROL0071H	ROLP850	ROLR1200PDH
Description	28" Roller, Breaker & Trailer	Trench/utility roller with dual drums and remote-control operation	Compact padfoot roller for efficient soil compaction in tight spaces
Model	Terex MBR71	Dynapac D.ONE	BW 124 PDH
Length (mm)	2,200	1,897	3,450
Height (mm)	1,245	1,275	2,491
Weight (kg)	512	1,585	3,880
Drum Width Front (F)	710 (F)	610	1,200
Rear (R) (mm)	6.7 (F)	850	1,200
Static Linear Front (F)	9	N/A	19.5
Rear (R) (kg/cm)	N/A	N/A	17.3
Centrifugal Force k(N)	N/A	72	85

We have a large fleet of compact ride-on tandem rollers from 0.8m up to 10 tonnes. Some of the many benefits of these rollers include:

✓ Compact design ✓ Wasp-waist for greater visibility ✓ Low machine height ✓ Intuitive operator controls

RIDE-ON TANDEM ROLLERS

CODE	ROLR0800H	ROLR1000	ROLR1200H*	ROLR1300*	ROLR1600* **	ROLR1500
Description	0.8m Ride-on Tandem Roller	1m Ride-on Tandem Roller	1.2m Ride-on Tandem Roller	1.3m Ride-on Tandem	10 Tonne Tandem Vibrating Roller	10 Tonne Tricycle Roller
Model	Hamm HD8	Hamm HD10CVV	Hamm HD12VV	Hamm HD13VV	Hamm HD90	Model Hamm HW90B
Length (mm)	1,862	2,177	2,454	2,690	4,600	2,500
Height (mm)	2,300	2,155	2,382	1,820	3,040	1,250
Weight (kg)	1,600	1,575	2,705	4,920	9,190	1,500
Drum Width (mm)	856 (F)	710 (F)	1,265 (F)	1,350 (F)	1,680 (F)	850
Static Linear Load Front (F)/Rear (R) (kg/cm)	9.6/10.2	7(F)	11.2/11.4	15.5/15.1	27.6/27.1	19/17
Centrifugal Force Front I/II (kN)	25/16	25/16	52/32	64/39	75/60	30/20
Centrifugal Force Rear I/II (kN)	25/16	25/16	52/32	64/39	75/60	25/15

* Option of cutting wheel attachment | ** Option of Chipper Box

For earth work our range of all-terrain self-propelled rollers give you the compaction force needed. Uneven ground is easily compacted thanks to the 3-point articulation that allows well balanced weight distribution. Additional benefits include:

✓ Climbing ability of up to 40° ✓ Intuitive operator controls ✓ Large linear load of up to 62kg/cm controls

ROLR2000

12 Tonne Self Propelled Roller



ROLR2016

16 Tonne Self Propelled Roller



SELF-PROPELLED ROLLERS

CODE	ROLR2000	ROLR2016
Description	12 Tonne/13 Tonne Self-propelled Roller*	16 Tonne Self-propelled Roller*
Model	Hamm HC130i	HC160i
Length (mm)	5,850	5,850
Height (mm)	2,960	2,282
Weight (kg)	12,890	16,150
Drum Width (mm)	2,140 (F)	2,140 (F)
Static Linear Load Front (kg/cm)	36.7	50.3
Centrifugal Force Front I/II (kN)	249/209	352/349

* Padfoot also available



POWER & LIGHTING

From small portable generators to power small tools onsite to large super-silenced units to 300KVA to power accommodation compounds at site start up, tower cranes or as temporary back up, we have a size and specification for most applications. These include Silenced, Super-silenced, Single Phase, 3 Phase and Multi-voltage for standard or unlimited running times. An installation and commissioning service is also available. Essential where Health & Safety, Security, Road Closures and Productivity are an issue. Our new Eco lights offer tremendous fuel savings and extended running times over traditional Metal Halide units.

Complementary products for this range: ✓ Refuellers ✓ Distribution boards

“I have had a great working relationship with Jarvie for over 10 years, during this time the Jarvie team have never failed to support our business requirements.”

- Energy Company



GAWG-045S
JCB G45QS Generator



GAWG-160S
JCB G165QS Generator

GENERATORS

CODE	GAWG-016	GAWG-020S	GAWG-035S	GAWG-045S
Manufacturer	Stephill	JCB	JCB	JCB
Model	SSDK16M	G20QS	G33QS	G45QS
Prime/Standby KVA	14.5/16.0	18.1/19.9	30.9/34.0	40.7/44.8
Dimensions L/W/H	1,800/800/1,270mm	1,750/790/1,350mm	2,250/840/1,350mm	2,250/840/1,350mm
Manufacturer		Himoinsa	Himoinsa	Himoinsa
Model		HRYW-50	HRYW-35	HRYW-45
Prime/Standby KVA		20.0/22.0	37.0/34.0	41.0/45.0
Dimensions L/W/H		2,150/1,025/1,329mm	2,150/1,025/1,329mm	2,150/1,025/1,329mm

CODE	GAWG-065S	GAWG-100S	GAWG-150S	GAWG-045S
Manufacturer	JCB	JCB	JCB	JCB
Model	G65QS	G115QS	G165QS	G220QS
Prime/Standby KVA	57.7/64.6	105.0/115.5	150.0/165.0	200.20/220.20
Dimensions L/W/H	2,750/1,140/1,850mm	2,850/1,140/1,850mm	3,800/1,140/2,075mm	3,800/1,140/2,050mm
Manufacturer	Himoinsa	Himoinsa	Himoinsa	Himoinsa
Model	HRFW-60	HRFW-100	HRGW-160	HRFW-200
Prime/Standby KVA	59.0/63.0	100.0/107.0	160.0/175.0	200.0/220.0
Dimensions L/W/H	2,810/1,150/1,793mm	2,810/1,150/1,793mm	3,300/1,200/1,956mm	3,360/1,250/1,997mm

BATTERY POWER STORAGE SYSTEM

Implementing eco-friendly equipment and practices overnight in sensitive areas delivers multiple benefits. By optimising fuel efficiency and incorporating technologies such as hybrid or electric systems, significant fuel savings can be achieved, reducing operational costs. These measures also contribute to substantial carbon reduction,

supporting sustainability goals and compliance with environmental standards. Additionally, low-emission engines and advanced noise-control features ensure whisper-quiet operation, minimising disruption in noise-sensitive zones and enhancing community relations.





To compliment our generators we offer a range of accessories including:

- Secure 'Power Stores' to Contain Generators up to 100kva with Integral Bundled long range fuel tank and distribution Board
- Battery Storage Units up to 45kva Output with 90kWh of usable Storage
- Distribution boards - 4 < 24 Module Hard Wired
- Distribution boards with Sockets - Plug & Play
- Automatic Mains Failure Switch over Panels for critical backup
- Cabling
- Solar Panels
- EV Chargers
- Fuel Management Service

POWER STORES

For sites where space and security are a concern our power stores are the ideal solution. We package a generator, fuel tank and distribution board in one unit.

CODE	GAWG-040PS	GAWG-100PS
Description	40 kVA Power Store	100 kVA Power Store
Model	Generator, long-range fuel tank and distribution board within one compact unit	Generator, long-range fuel tank and distribution board within one compact unit
Fuel Tank Capacity	1,880 Litres	1,880 Litres

TOWERLIGHTS

Our range of towerlights are the ideal product to help you maintain your productivity and safety on site whilst keeping your costs down during the winter months and shorter daylight hours.

The VB-9 Eco Tower offers:

- ✓ A 72% reduction in fuel costs, saving over £127 per week compared to traditional lighting towers
- ✓ Average 20 lux coverage over 3600m²
- ✓ 340 hrs running time on 170 litre long run fuel tank
- ✓ Wind stable up to 100 km/h

The VT-Hybrid offers:

- ✓ Quiet running
- ✓ Up to 700 hours runtime from 160 litre fuel tank
- ✓ 4x150w LED floodlights
- ✓ Monthly fuel reduction of £220
- ✓ Carbon emissions reduced by 47%

LIGHTING

CODE	GAWL-11X	GAWL-12X
Description	Diesel-powered LED lighting tower for construction, rental, events, trackside projects. Provides energy-efficient illumination and compact transportability.	9m Mobile Tower-light
Model	X-Eco 6×160 W 48 V LED	VT-9 Hybrid
Feature	Equipped with 6 high-output LED floodlights, a Stage V Kubota diesel engine, and an 8.5m hydraulic mast with 340° rotation. It offers long runtime (up to 200 hours), low fuel consumption, compact transportability, and advanced safety features including AMOSS mast-lowering and fully bunded tank.	Super fuel efficient, up to 320hr runtime, hydraulic vertical mast, rail track approved. Wind stable up to 100kmh. Led lights. 170 Litres fuel tank.



BOWSERS & COMPRESSORS

We have a range of mobile and static water and fuel bowzers. Our water bowzers range in size from 250 gallons to 2,000 gallons providing water solutions to a wide variety of applications. If you have a site which has no mains water supply our water bowzers which come with a secure lockable access hatch, load lifting eyes & fork pockets for ease of handling, internal baffles for safe towing are the ideal solution. Our bunded fuel bowzers can provide from 85 to 4,000 gallons of fuel and are provided with secure lockable access hatches and dispensing meter. Our Compressor range is from 85cfm to 880cfm with pressure up to 175psi. A range of accessories and tools is also available. All our Compressors are road towable and can be fitted with Chalwyn Valve and Spark Arrestor for Petrochemical facilities.



With environmental issues of prime importance on site, all of our fuel bowzers and tanks are bunded. This provides our customers with extra leakage protection from our varied and modern fleet. In addition, we offer a refilling and emptying service for water supply tanks and effluent tanks. Our bowzers are easily stacked and come with

lifting eyes and forklift pockets reduces storage space. With an access manhole for easy maintenance and inspections. All our highway towable bowzers are fitted with rubber suspension and internal baffles that prevent surges when towing.

HIGHWAY BOWSERS

CODE	BOWMF200	BOWMF440H	BOWMW250P	BOWMW500P
Description	950ltr Fully Bunded Hiway Fuel Bowser	2,000lt Twin Axle Fully Bunded Hiway Fuel Bowser	1,000ltr Poly Hiway Water Bowser	2,000ltr Poly Hiway Water Bowser
Accessories	12v/24v/110v Pump and dispensing meter	12v/24v/110v Pump and dispensing meter	2" Petrol Water Pump/Dust Suppression Kit/200bar Diesel Pressure Washer & Lance	

STATIC TANKS

CODE	BOWSF0250	BOWSF0500	BOWSF2500
Description	1,000ltr Bunded Site Fuel Tank c/w Semi-Rotary Hand Pump	2,000ltr Bunded Site Fuel Tank c/w Semi-Rotary Hand Pump	Range of Bulk Fuel Tanks from 4,000ltr → 20,000ltr
Accessories	12v/24v/110v Pump and Dispensing Meter - Fuel Management Telemetry		12v/24v/110v Pump/1" Petrol Pump/Dispensing Meter - Fuel Management Telemetry



COMPRESSORS

Our fleet of compressors is able to cope with most applications on building, construction, civil engineering and petrochemical contracts. Our fleet ranges from standard "1 & 2" tool compressors to medium, large and high pressure units for specialised applications. All compressors can be fitted with spark arrestors and Chalwyn valves for use in potentially flammable areas.

CODE	COM130B	COM130CV	COM250
Description	140cfm Bunded Compressor	140cfm Bunded Compressor	260cfm Compressor
Features	Hardhat, Impact Resistant Canopy - Excellent Service Access	Hardhat, Impact Resistant Canopy - Excellent Service Access, Petro Chem Spec	Integrated Aftercooler

CODE	COM400	COM400H	COM-E
Description	400cfm Hi-Way Compressor	400cfm CVSA Hi-Way Compressor	Electric Compressor
Features	Easy Maintenance, Adjustable Towbar, 170ps Model Available	High Pressure 170 psi	-

COMPRESSORS TOOLS



COMT-112
Vibrating Reduced Light Pick



COMT-200
Vibrating Reduced Light Pick



COMPT-520
Air Poker

AIR TOOLS

CODE	COMT-110	COMT-112	COMT-115	COMT-130
Description	Light Pick	Vibrating Reduced Light Pick	Light Chipping Hammer	Light Rotary Hammer

CODE	COMT-170	COMT-200	COMT-520
Description	Air Pistol Drill	Vibrating Damped Medium Breaker	Air Poker



JARVIE PLANT **CASE STUDY**

Challenge:

Ensuring Compliance with Main Contractor's Safety Specifications for a school project.

Solution:

We implemented the VCAS system and enhanced visibility by painting handrails, footsteps, and the boxing ring in high-visibility colours.

Results:

The equipment was successfully delivered and received positively on-site, contributing to a safer and more compliant environment for the school.



SMALL PLANT

Our range of small plant equipment will keep your project moving. All equipment is available for short or long term hire. We stock a good selection of commonly hired smaller plant and tools available from all our depots. If we don't have what you are looking for let us know and we'll do our best to source it for you next time.



SAW-03820
Clipper 350mm Petrol Floor Saw



MIS-365
Cable Detection



PUMP-0050
2" Submersible Pump

GENERAL EQUIPMENT

CODE	SAW-0365	SAW-03820	SPT-200	SPT-210	MIS-365	MIS-0100
Description	Stihl Hand Saw	450mm Petrol Floor Saw	JCB Beaver Hydraulic Power Pack	Hydraulic Breaker with 7m Hydraulic Hose	Cable Detection	Steel Road Plate/Anti Skid Road Plate

CODE	SPT-250	SPT-300	SPT-435	SPT-450	MIS-0670	MIS-375
Description	Hydraulic Drill	Cobra Petrol Breaker	240V Convector Heater	Infrared Heater 110V 2kw	Herras Fencing	Gas Monitor

CODE	SPT-057	SPT-060	SPT-080	SPT-100	SPT-120	PUMP-0400
Description	100V Pencil Grinder	Drill	0.5" Impact Drill	110V HILTI TE74 Ham Drill	110V Kango Breaker	Dehumidifier

CODE	PUMP-0050	PUMP-0100	SPT-460	SPT-6553	SPT-140
Description	2" Submersible Pump	2" Petrol Pump	Fan Heater	100V Red Rad Heater	Cordless Drill, Battery + Charger

JP Preferred - Ground mats, Barriers and Fencing. If you don't see what you need please let us know and we will source it for you

TOUGH TO BEAT



SCOT JCB

JCB

Introducing the new Generation 25Z-I and 26C-I JCB mini excavator: designed with durability, reliability and towability in mind.

MINI EXCAVATOR | 25Z-I / 26C-I
2.5T ZERO & CONVENTIONAL TAIL SWING COMPACT EXCAVATORS

Operating weight: 2550 – 2675kg Gross engine power: 18.4kW
Bucket tearout: 22.3 – 25.9kN

JCB

For more information visit our website.

Call 0141 556 6521

www.scot-jcb.co.uk



RPCP060P
60kg 330mm Vibrating Plater with Water Tank



RPCP150D
169kg 460mm Forward / Reverse Diesel Vibrating Plate

RAMMERS & PLATES

CODE	RPCP045P	RPCP060P	RPCP070P
Description	45kg 300mm Petrol Vibrating Plate	60kg 330mm Vibrating Plater with Water Tank	400mm Vibrating Plate

CODE	RPCP150D	RPCT050P
Description	169kg 460mm Forward / Reverse Diesel Vibrating Plate	Rammer 160mm Foot

ALSO
AVAILABLE

Small Plant

Auger: Augers for Digging Holes

Shears: DEWALT 18-Gauge Shear Attachment



MIX-150P
4/3 Tip-Up Petrol Mixer with Stand



RPCP150D
169kg 460mm Forward / Reverse Diesel Vibrating Plate

KERB LIFTING EQUIPMENT

CODE	HALK-220	HALK-200	HALK-110	HALK-300
Description	P-VPH Batter/ Vacuum Handler	PT Vacuum Stone Magnet	TSZ-Uni Kerb Lifter	Diesel Vacuum, Block Lifter and Trailer

CONCRETE EQUIPMENT

CODE	MIX-050	MIX-150P	MIX-300E
Description	Tubmix Mixer	4/3 Tip-Up Petrol Mixer with Stand	7/5 Diesel Mixer with Electric Start

CODE	MIXA-338	MIXA-340
Description	Electric 110V HF Poker	Flex Drive Poker 1" - 3.5"



ACCOMMODATION



HI SECURE

We have a comprehensive range of high secure steel units form 12ft to 32ft including offices of various layouts, canteens, drying rooms and toilets and showers to meet any site requirements, the range includes;

- ✓ Premium/Eco Units
- ✓ Fire Rated
- ✓ Blast Rated
- ✓ Night Rest (Sleeper Units)
- ✓ Safe Stores

WELFARE

We offer a range of mobile and static welfare units designed to provide welfare facilities fully in compliance with Health and Safety & CDM requirements when there are no manned services available on site. Features include Fully solar powered units, Eco hybrid power systems, chemical and water flushing toilets.

MODULAR JPX

JPX Modular Buildings offer a flexible modular system of high quality accommodation. Bespoke buildings tailored to meet your specific requirements can be achieved efficiently and cost-effectively. We will design a layout that can include open plan/ individual sized offices, meeting rooms, kitchen/canteen areas, drying rooms, toilets/showers & sales suites. Our modular system maximises every square foot transforming it into functional and usable accommodation.

ECO SETTLER 13' MOBILE UNIT

Length (mm)	4,000 (13')
Width (mm)	2,330 (7'6")
Code	AC62-3000

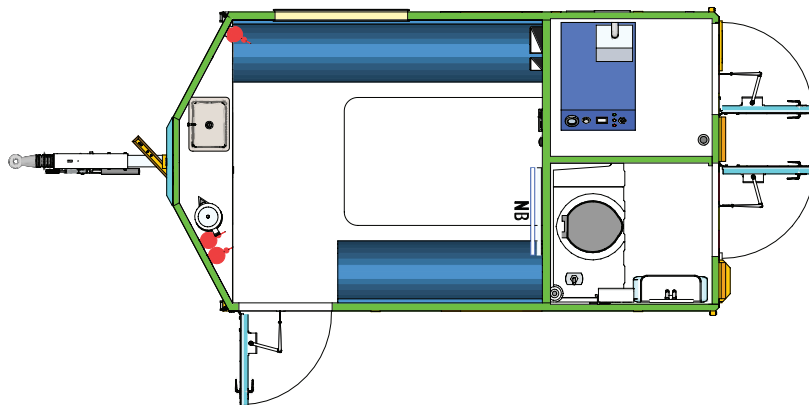

AC62-3000
Eco-Settler 7-man Welfare Unit

SEATING
FOR UP TO



PEOPLE

Settler Unit

The Settler seats seven people comfortably, built in steel with anti-vandal doors and window shutters and lowers to the ground when in use.

Features

- ✓ Hybrid Power System is self starting and self-managing battery/inventor/generator system.
- ✓ Canteen with soft seating for seven.
- ✓ Kitchen area including microwave and kettle.
- ✓ Toilet with fore-arm sink.
- ✓ Weekly Chemical Toilet Service.
- ✓ Drying area.
- ✓ Hybrid Power System.
- ✓ Generator runs automatically when required to power appliances or recharge batteries.
- ✓ Suitable for 24 hour use with silent running.
- ✓ PIR controlled LED lighting.

ECO 16' RANGE

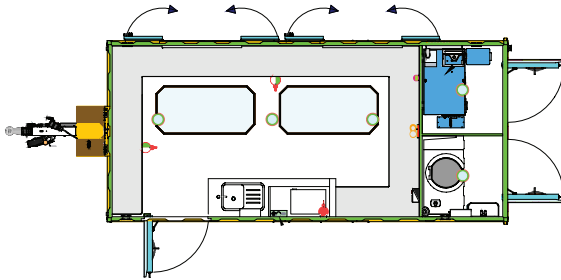

AC62-4000
Eco-Voyager 14-man Welfare Unit

SEATING
FOR UP TO
14
PEOPLE

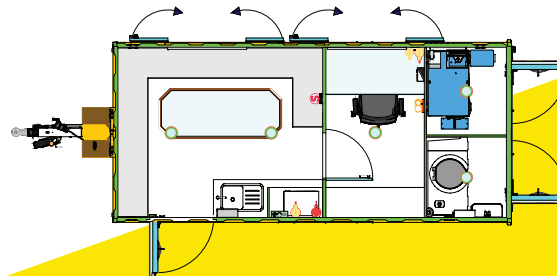

AC62-5000
Eco Pilot - 8-man Welfare Unit

SEATING
FOR UP TO
8
PEOPLE
+ OFFICE

Length (mm)	5,000 (16')
Width (mm)	2,300 (7'5")

Features

- ✓ **Hybrid Power System** is self starting and self-managing battery/inventor/generator system.
- ✓ Generator runs automatically when required to power appliances or recharge batteries.
- ✓ Suitable for 24 hour use with silent running.
- ✓ **Sustainable Power:** Utilises solar panels and batteries to reduce fuel consumption.
- ✓ **Hybrid Power System.**
- ✓ **Comfort and Safety:** Includes amenities like warm water and air-blown heating, with high-security doors and smoke detectors.
- ✓ **Timer** shuts down generator when not in use.
- ✓ **Energy Efficiency:** Intelligent power management systems optimise energy use.
- ✓ **Modular and Quiet:** Designed for easy transport and configuration, with quiet operation to minimise noise pollution.

SOLAR PILOT 16' MOBILE UNIT

SEATING
FOR UP TO

8 

PEOPLE + OFFICE

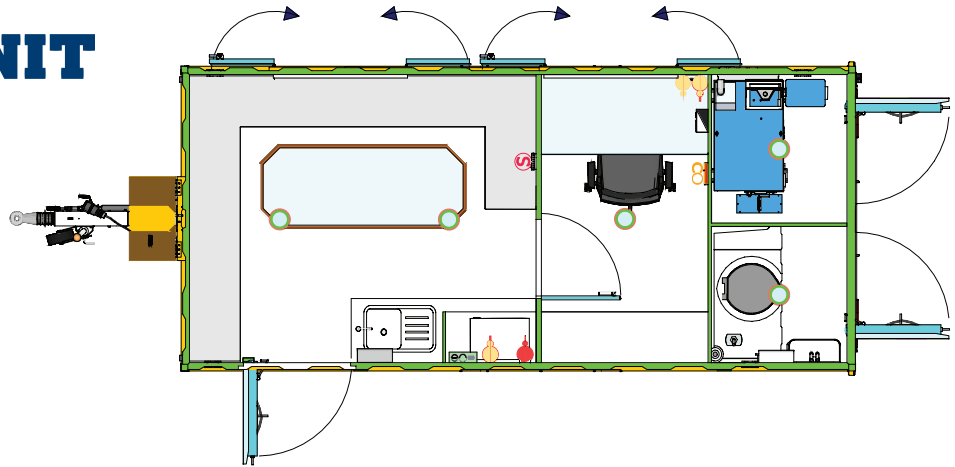

AC62-7165
Solar range - Voyager Pilot - 8-man Welfare Unit

Length (mm)	5,000
Width (mm)	2,300
Code	AC62-7165

The Solar Range Voyager Pilot is a versatile and efficient accommodation unit designed for mobile off-grid applications. It combines high-efficiency monocrystalline solar panels with a 20A Voyager charge controller, making it ideal for situations where space and weight are limited.

Features

- ✓ **High-Efficiency Monocrystalline Solar Panels:** Ensures maximum power output.
- ✓ **20A Voyager Charge Controller:** Manages the solar power efficiently.
- ✓ **Compatibility:** Supports various 12V deep cycle battery types including sealed lead-acid, gel, and flooded.
- ✓ **Built-in Tilting Stands:** Allows adjustment of panels to optimize sunlight capture.
- ✓ **Alligator Clips with MC4 Connectors:** Facilitates quick and easy battery connections.
- ✓ **Plug-and-Play Design:** Easy to set up and use.
- ✓ **LCD Display:** Provides clear solar charge information.
- ✓ **HSE compliant hot wash station.**
- ✓ **Durable and Portable:** Designed for mobility and durability in off-grid environments.

ADMIRAL 24' WELFARE UNIT

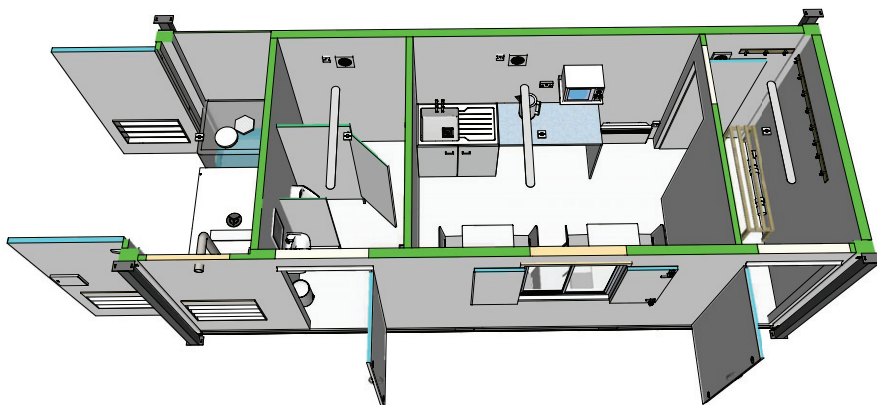

SEATING
FOR UP TO



PEOPLE

Admiral 24'x9' - Welfare Unit

Length (mm)	7.30m
Width (mm)	2.70m

Features

- ✓ Canteen with sink, hot water, worktop, microwave and kettle.
- ✓ Large walk-through hanging/drying area before canteen.
- ✓ Toilet with water flush WC and urinal.
- ✓ Choose weekly, fortnightly or unscheduled toilet servicing.
- ✓ HSE compliant hot water wash station in toilet.
- ✓ Large water and waste tanks (700litre and 800litre).
- ✓ 13kVA generator with ample power for all on-board equipment.
- ✓ Power take-off to power an additional office or other unit if required.
- ✓ 270litre fuel tank to run 125-150 hours between fills.
- ✓ Engine modification kit as standard to extend oil change interval to 1,000 hours.

HARBOUR 20' WELFARE UNIT

SEATING
FOR UP TO

8 

PEOPLE

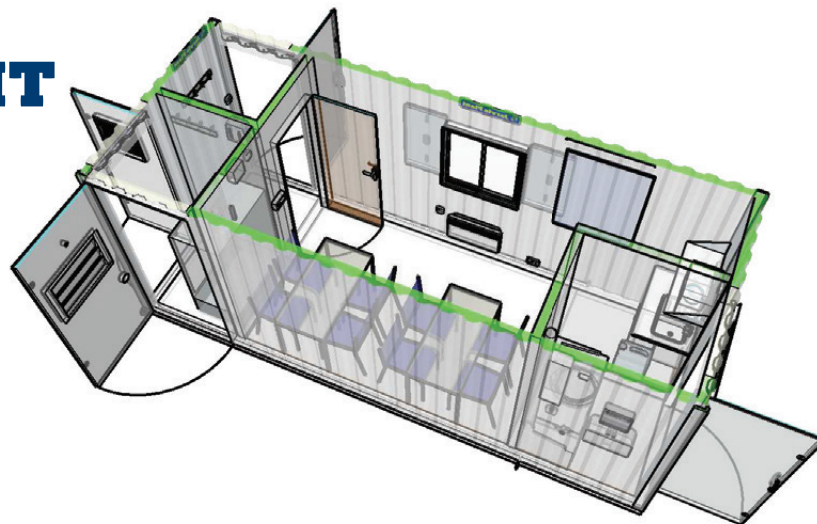

20' Harbour - 8-man Welfare Unit

Length (mm)

6.05m

Width (mm)

2.44m

The 20' Harbour Welfare Unit is a comprehensive and portable solution designed to provide essential facilities for workers in remote or temporary locations. It combines modern amenities with sustainable features to ensure comfort and efficiency.

Features

- ✓ **Integrated Diesel Generator:** Provides reliable power.
- ✓ **Canteen Area:** Equipped with table and bench seating for up to 8 people.
- ✓ **Hot & Cold Water Supply:** Ensures hygiene and convenience.
- ✓ **Toilet Compartment:** Includes a re-circulating flush tank toilet with a 170-litre capacity.
- ✓ **USB Charging Points:** Convenient for charging electronic devices.
- ✓ **Drying Room:** Facilitates drying of clothes and equipment.
- ✓ **Stainless Steel Worktops & Sink:** Durable and easy to clean.
- ✓ **Thermostatically Controlled Heating:** Maintains a comfortable temperature.
- ✓ **PIR Activated Lighting:** Reduces energy consumption.
- ✓ **Hydraulic Axles:** Allows quick setup in as little as 30 seconds.

ISLAND 25' WELFARE UNIT

SEATING
FOR UP TO
 **12**
 PEOPLE

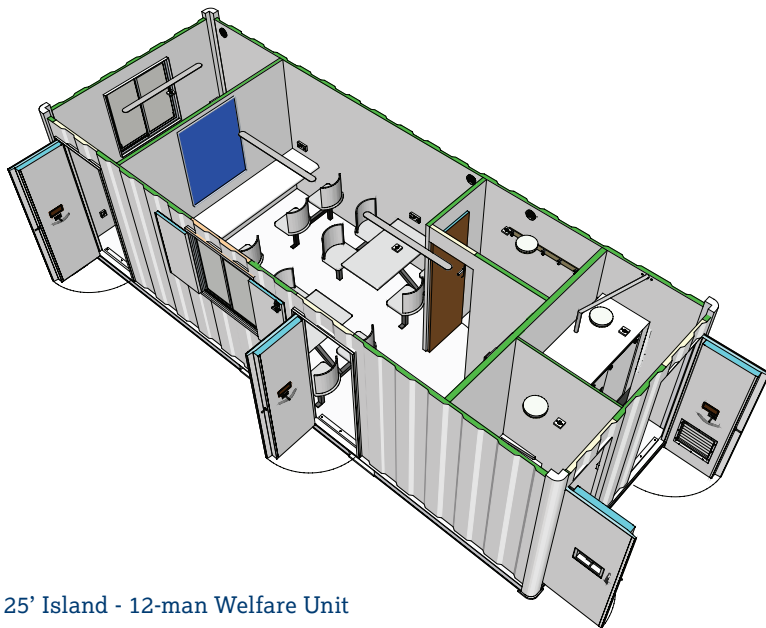

25' Island - 12-man Welfare Unit

25' Island Welfare Unit is a spacious and well-equipped accommodation solution designed to provide essential facilities for workers in remote or temporary locations. It combines modern amenities with robust construction to ensure comfort and efficiency.

Length (mm)	7.60m
Width (mm)	2.75m

Features

- ✓ **Integrated Diesel Generator:** Ensures a reliable power supply.
- ✓ **Canteen Area:** Equipped with table and bench seating for up to 12 people.
- ✓ **Hot and Cold Water Supply:** Provides hygiene and convenience.
- ✓ **PIR Activated Lighting:** Reduces energy consumption.
- ✓ **USB Charging Points:** Convenient for charging electronic devices.
- ✓ **Toilet Compartment:** Includes a re-circulating flush tank toilet with a 200-litre capacity.
- ✓ **Drying Room:** Facilitates drying of clothes and equipment.
- ✓ **Stainless Steel Worktops and Sink:** Durable and easy to clean.
- ✓ **Thermostatically Controlled Heating:** Maintains a comfortable temperature.
- ✓ **Hydraulic Axles:** Allows quick setup in as little as 30 seconds.

ECO ISLAND 24' WELFARE UNIT

SEATING FOR
12+ 
PEOPLE + OFFICE

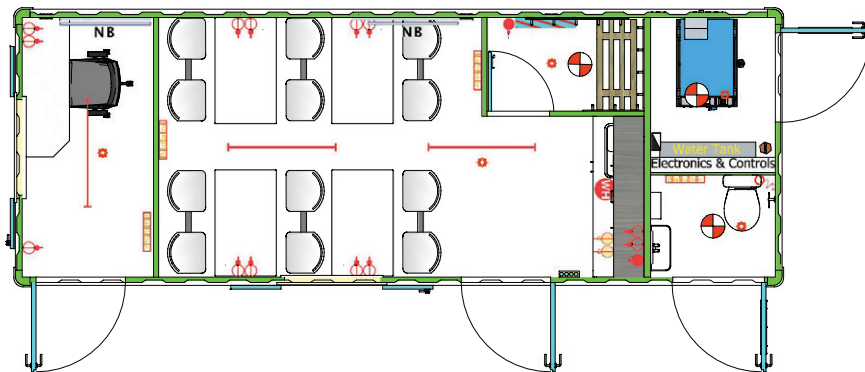

Eco Island - 12+-man Welfare Unit

Length (mm)

7.95m

Width (mm)

2.74m

Features

- ✓ **Integrated Diesel Generator:** Provides reliable power.
- ✓ **Canteen Area:** Equipped with table and bench seating for up to 8 people.
- ✓ **Hot & Cold Water Supply:** Ensures hygiene and convenience.
- ✓ **Toilet Compartment:** Includes a re-circulating flush tank toilet with a 170-litre capacity.
- ✓ **USB Charging Points:** Convenient for charging electronic devices.
- ✓ **Drying Room:** Facilitates drying of clothes and equipment.
- ✓ **Stainless Steel Worktops & Sink:** Durable and easy to clean.
- ✓ **Thermostatically Controlled Heating:** Maintains a comfortable temperature.
- ✓ **PIR Activated Lighting:** Reduces energy consumption.
- ✓ **Hydraulic Axles:** Allows quick setup in as little as 30 seconds.

Office Layout

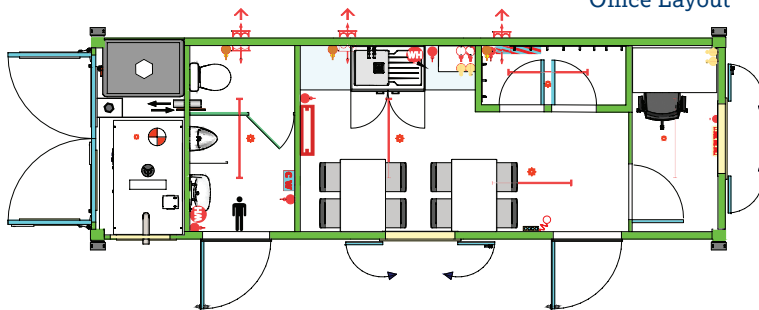

Canteen Layout

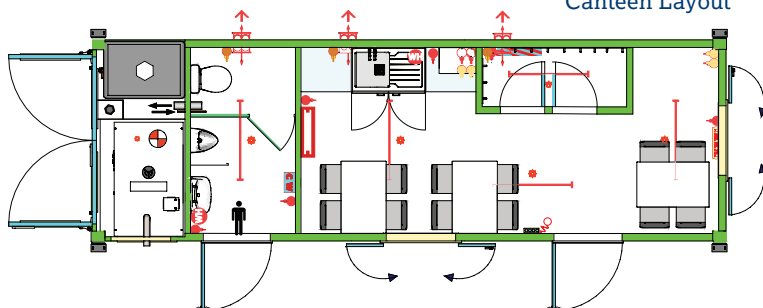

COMMANDER 28' WELFARE UNIT

SEATING
FOR UP TO

 **12+**

PEOPLE 8+ OFFICE

Length (mm)	8.5m
Width (mm)	2.7m
Code	AC62-1087

AC62-1087

28' Commander - 8-man + Office

Features

- ✓ **Integrated Diesel Generator:** Ensures a reliable power supply.
- ✓ **Canteen Area:** Equipped with table and bench seating for up to 12 people.
- ✓ **Hot and Cold Water Supply:** Provides hygiene and convenience.
- ✓ **PIR Activated Lighting:** Reduces energy consumption.
- ✓ **USB Charging Points:** Convenient for charging electronic devices.
- ✓ **Toilet Compartment:** Includes a re-circulating flush tank toilet with a 200-litre capacity.
- ✓ **Drying Room:** Facilitates drying of clothes and equipment.
- ✓ **Stainless Steel Worktops and Sink:** Durable and easy to clean.
- ✓ **Thermostatically Controlled Heating:** Maintains a comfortable temperature.
- ✓ **Hydraulic Axles:** Allows quick setup in as little as 30 seconds.

ENVOY WELFARE UNIT

SEATING FOR

20 

PEOPLE

16 + OFFICE

Length (mm)	9.75m
Width (mm)	2.72m
Code	AC62-1090

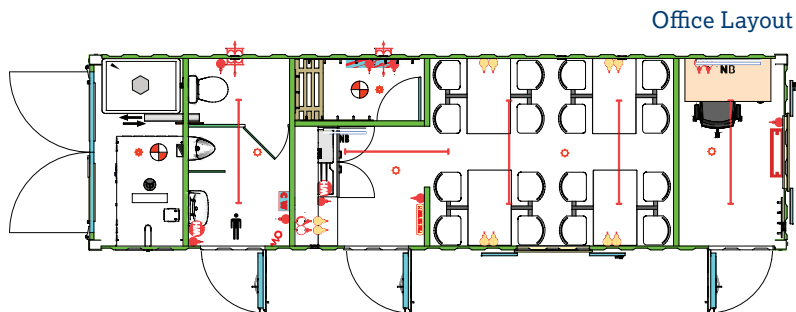

AC62-1090
32' Envoy - 16man + Office Welfare Unit

Features

- ✓ **Integrated Diesel Generator:** Provides reliable power.
- ✓ **Drying Room:** Facilitates drying of clothes and equipment.
- ✓ **Canteen Area:** Equipped with table and bench seating for up to 8 people.
- ✓ **Stainless Steel Worktops & Sink:** Durable and easy to clean.
- ✓ **Hot & Cold Water Supply:** Ensures hygiene and convenience.
- ✓ **Thermostatically Controlled Heating:** Maintains a comfortable temperature.
- ✓ **Toilet Compartment:** Includes a re-circulating flush tank toilet with a 170-litre capacity.
- ✓ **PIR Activated Lighting:** Reduces energy consumption.
- ✓ **USB Charging Points:** Convenient for charging electronic devices.
- ✓ **Hydraulic Axles:** Allows quick setup in as little as 30 seconds.



HIGH SECURE **ACCOMMODATION**

High Security - Our range of portable accommodation can be designed to suit your site needs, with many layouts and security features to protect for the duration of your project.

All our high-security units come with:

- ✓ **Heavy duty steel walls.**
- ✓ **Anti-vandal windows and doors.**
- ✓ **Flexible layouts.**

32' x 10' HIGH SECURITY UNITS

Secure 32'x10' unit with office, kitchen, toilet;
steel build, anti-vandal features, heating,
lighting - ideal for site use.

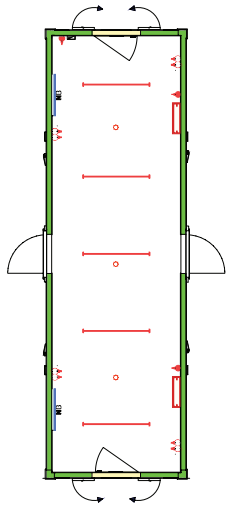

Open Plan Office
or Meeting Room

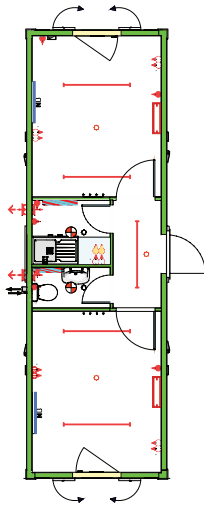

Office/Kitchen/
Toilet/Office

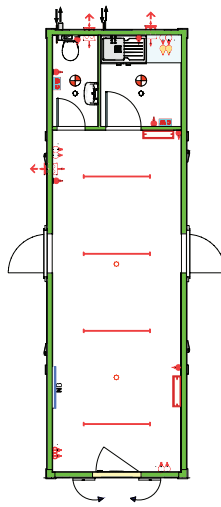

Open Plan
Office with
Kitchen & Toilet

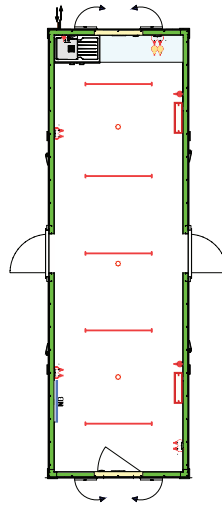

Open Plan
Office with
Mains Sink

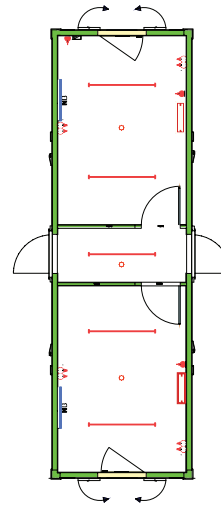

Office/
Corridor/Office

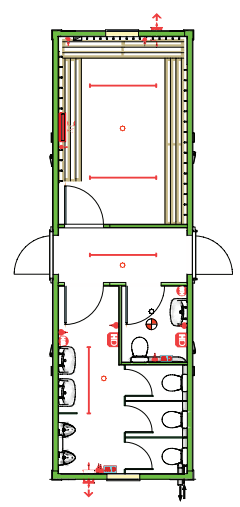

3+1 Toilet/
Drying Room

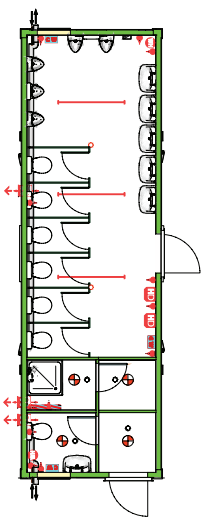

6+1 Toilet
With Shower

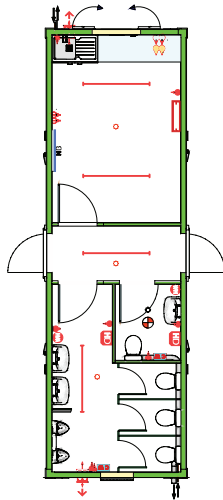

3+1 Toilet/
Corridor/Kitchen

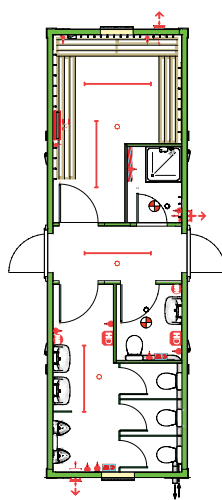

3+1 Toilet/
Shower/
Drying Room

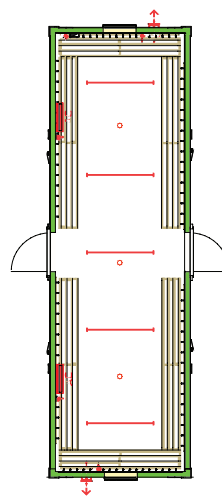

Open Plan
Drying Room

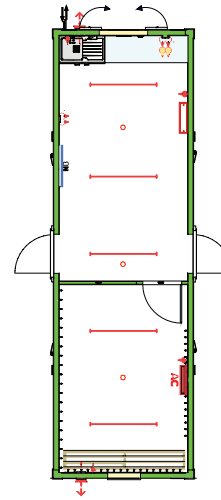

Drying Room/
Canteen

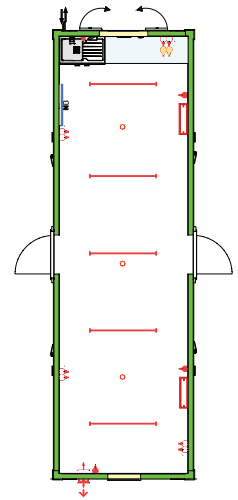

Open Plan
Canteen

24' x 9'

HIGH SECURITY UNITS

24'x9' steel unit with secure door, shuttered windows, heating, and lighting - ideal for safe, on-site accommodation.

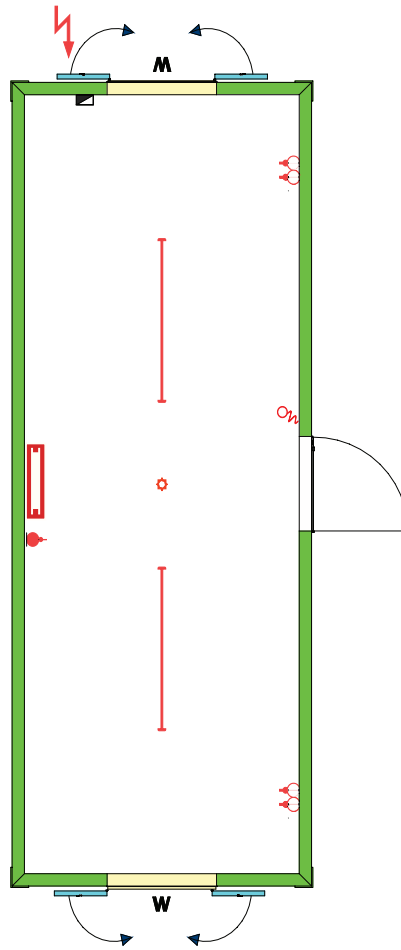

Open Plan Unit

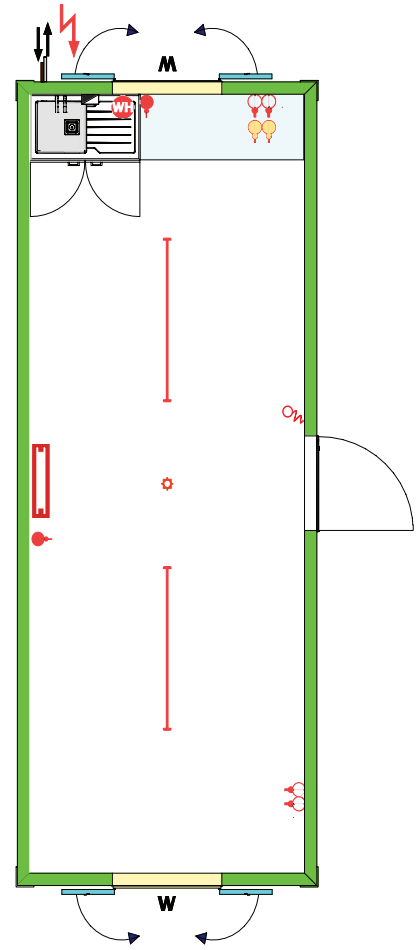

Mains Sink Unit

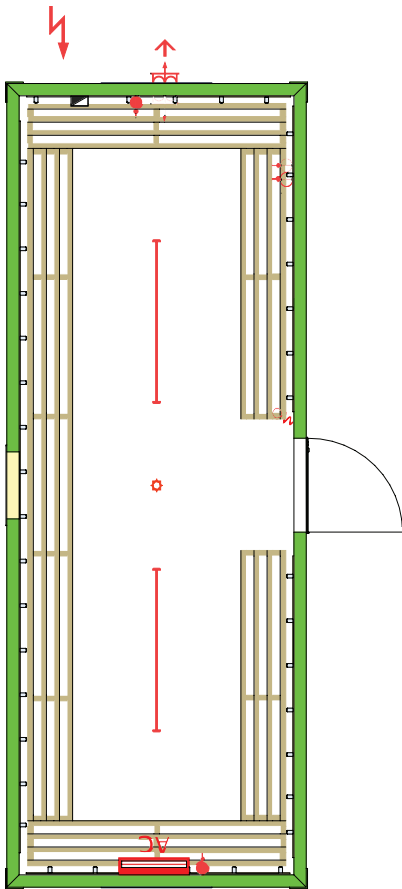

Drying Room

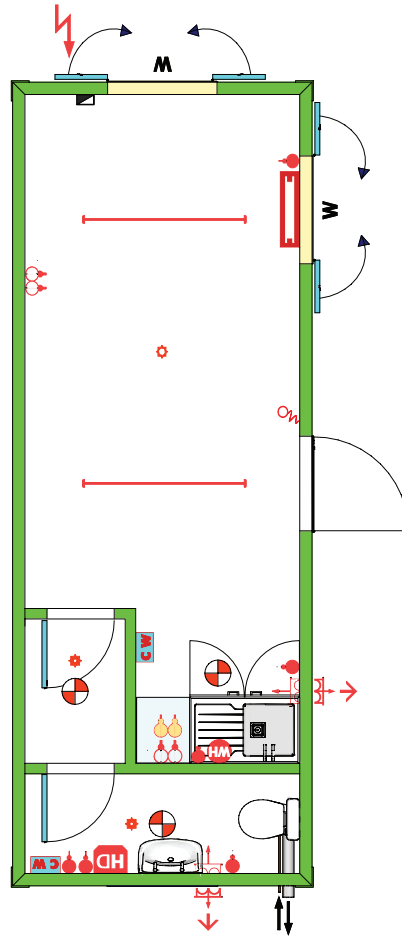

Office/Kitchen/Toilet

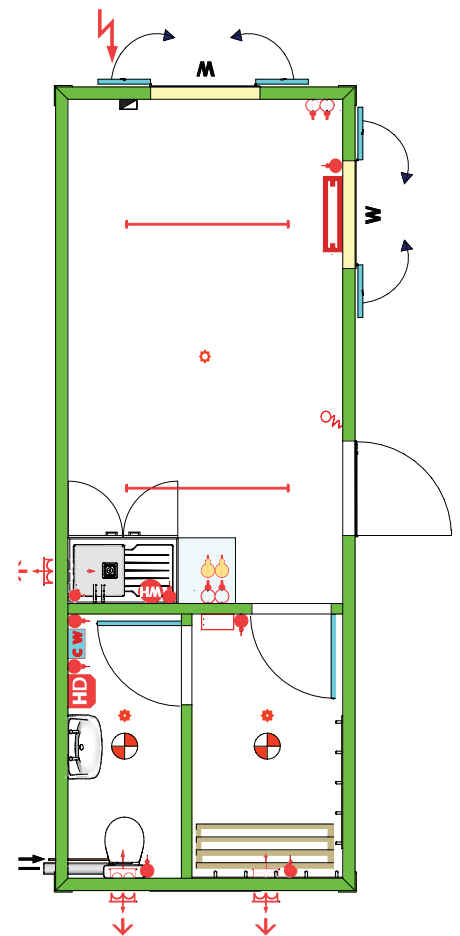

Canteen/Drying Room/
Toilet

LINKED UNITS

Spacious linked 4on4 32'x10' unit with open-plan layout, steel anti-vandal build, ideal for secure, multi-room site accommodation.



PLAN VIEWS

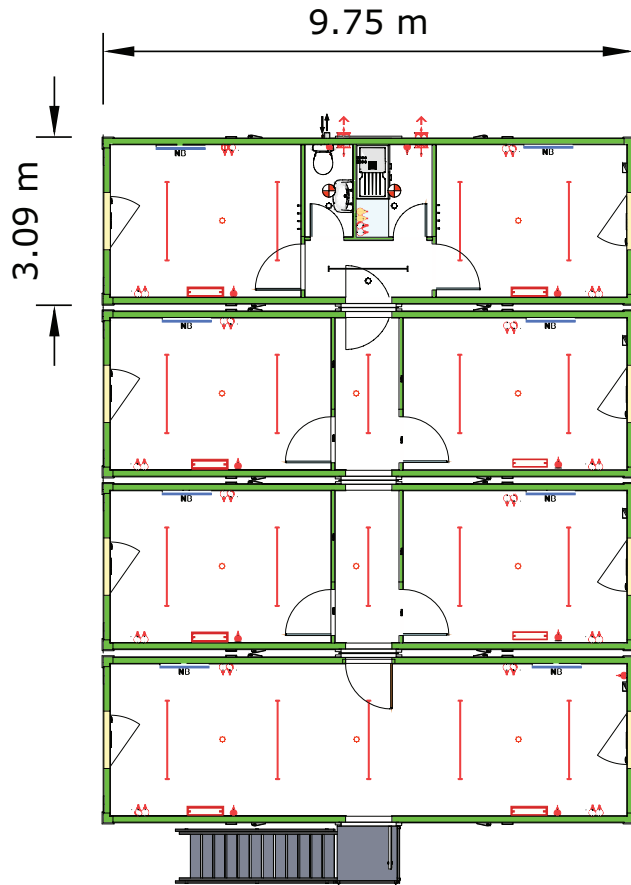

PLAN VIEW
First Floor

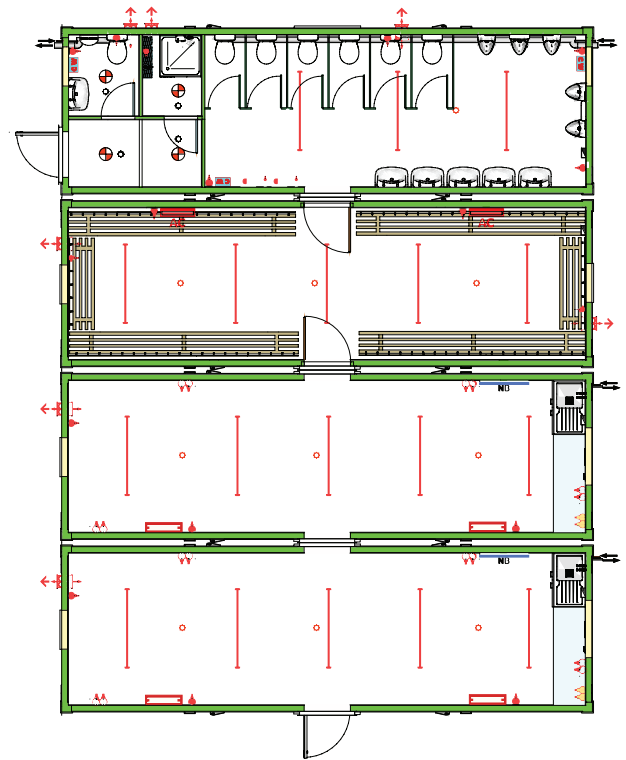

PLAN VIEW
Second Floor

20' / 16' / 12'

HIGH SECURITY UNITS

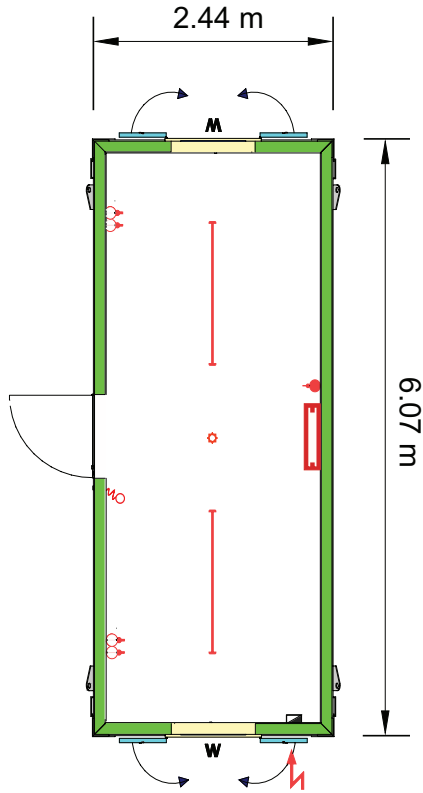

20' x 8' | Open
Plan Unit

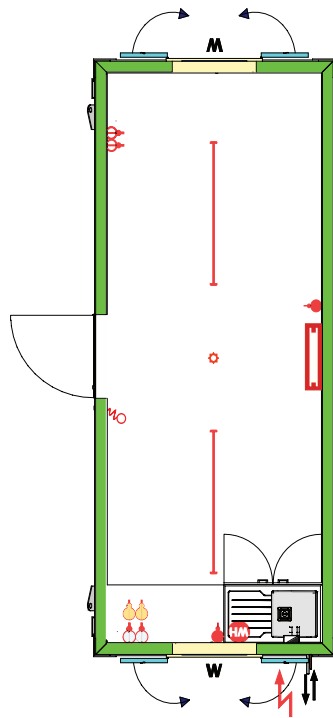

20' x 8' | Mains
Sink Unit

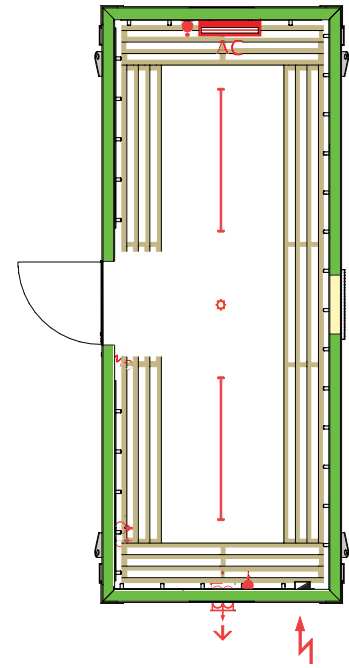

20' x 8' | Drying
Room

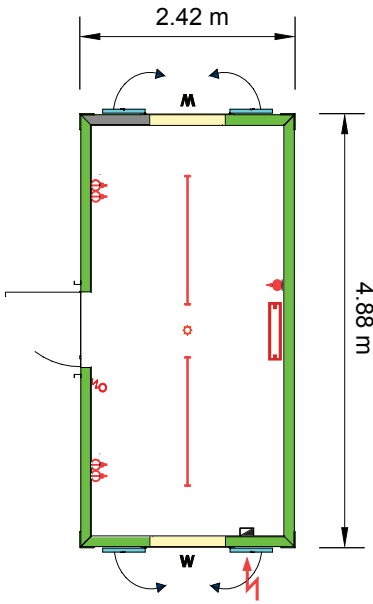

16' x 8' | Open Plan Unit

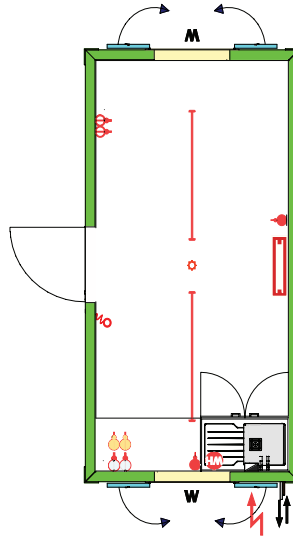

16' x 8' | Mains Sink Unit

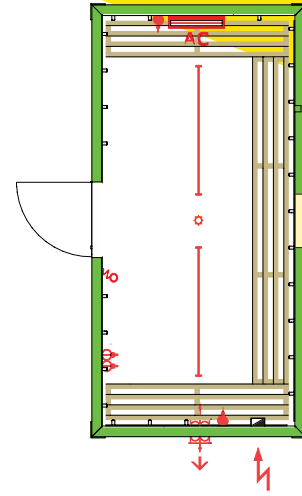

16' x 8' | Drying Room

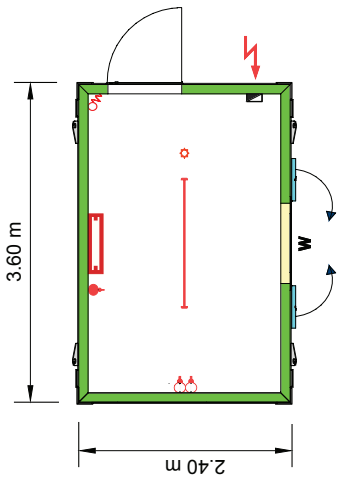

12' x 8' | Open Plan Unit

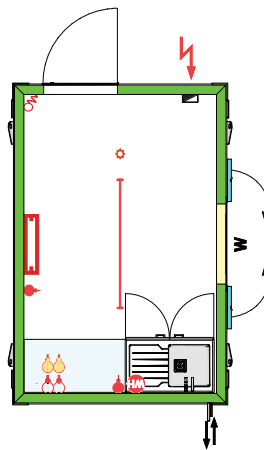

12' x 8' | Mains Sink Unit

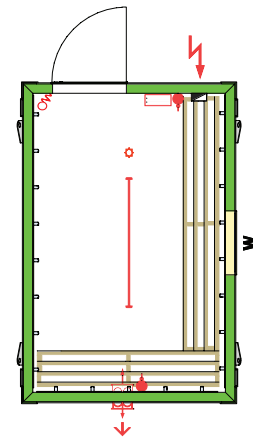

12' x 8' | Drying Room

HIGH SECURE TOILET RANGE

TOILET & SHOWER UNITS | HIGH SECURE

Our toilet units come in a wide range of layouts to suit site needs. All our units are made from heavy duty steel. Our specification includes:

- ✓ Heavy duty steel construction.
- ✓ Cistern miser to urinal.
- ✓ Dual flush WC cisterns.
- ✓ Under sink unvented water heaters with non concussive hot and cold push taps.
- ✓ Self-closers to exterior doors.

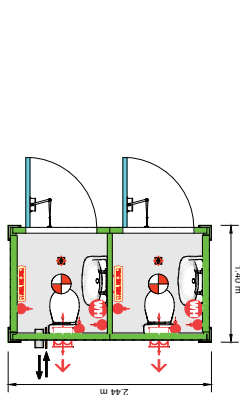

2WC (1+1)

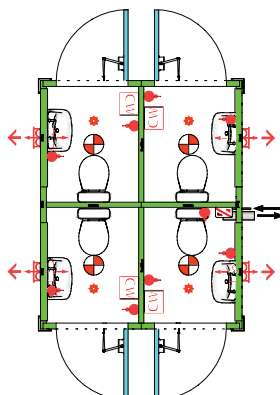

4WC

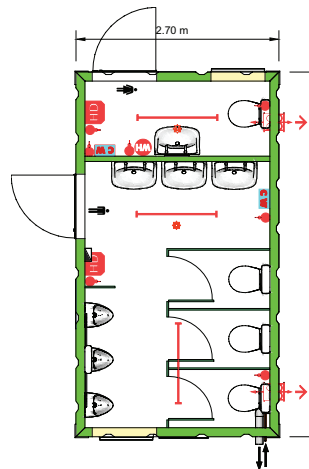

3+1

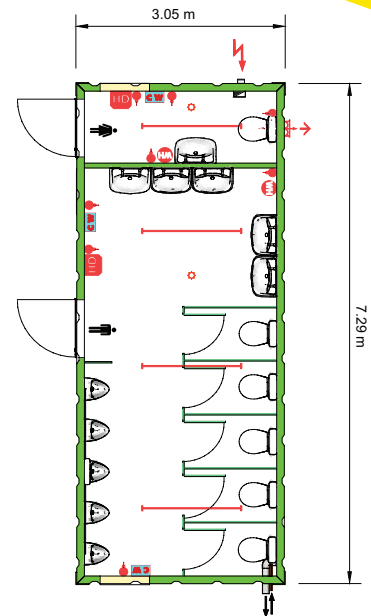

5+1

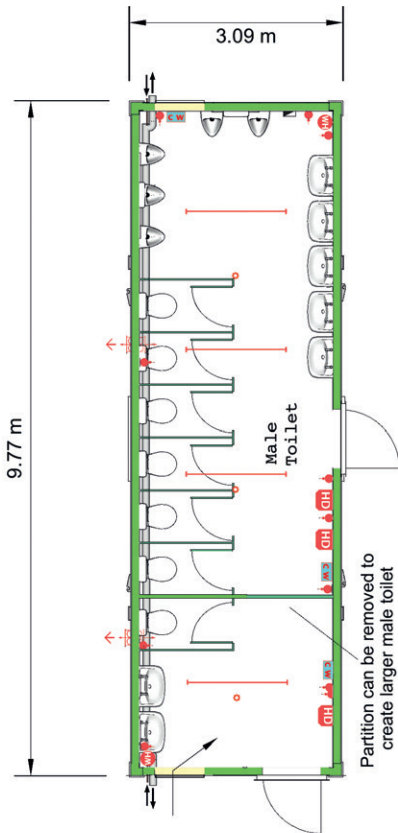

7WC (6+1)

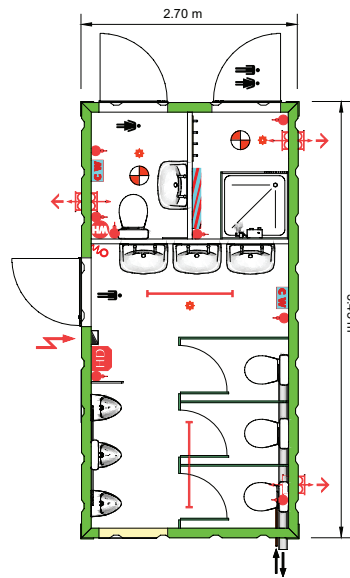

3+1 + Shower

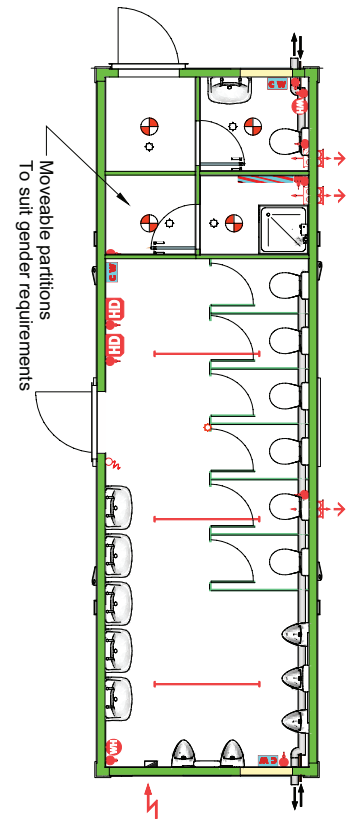

6+1 + Shower

FIRE RATED

JP Fire Rated units are designed and constructed to provide enhanced fire resistance and fire containment of 30 minutes, allowing time for safe evacuation and emergency response.

Government Fire Safety Order 2005

HSE – “HSG168 Fire Safety in Construction”
Joint Code of Practice (JCOP) for Fire Safety 2024

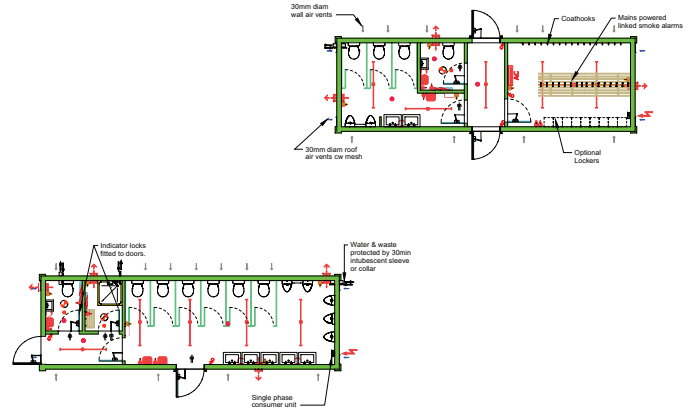
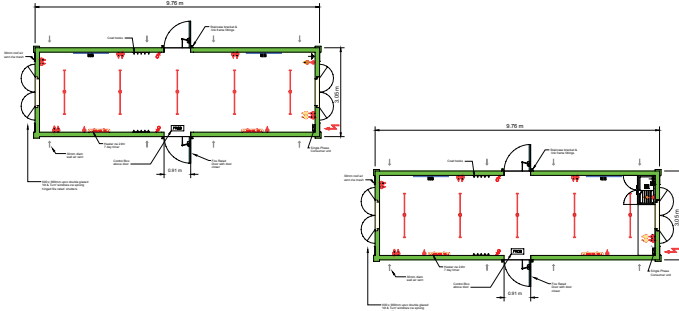

32' Office	
Dimensions	32 ft (L) x 10 ft (W)
Construction	Fire-rated steel structure
Security	High-security doors and steel window shutters
Interior Layout	Office, kitchen, and toilet facilities
Heating	Electric heating system
Lighting	Internal electric lighting
Power Supply	Standard electrical connections
Use Case	Site offices, secure storage, welfare units

32' Canteen	
Dimensions	32 ft (L) x 10 ft (W)
Construction	Fire-rated steel structure
Security	Steel personnel door, steel window shutters
Interior Layout	Open-plan canteen space
Sink	Mains-connected stainless steel sink
Water Heating	Electric water heater
Kitchen Fixtures	Worktop, kitchen cupboards
Lighting	Internal electric lighting
Heating	Electric convector heating
Flooring	Durable, easy-clean surface
Power Supply	Standard electrical connections
Use Cases	Site canteen, welfare unit

BLAST RATED

Blast-rated, anti-vandal accommodation units for hire - For site locations within areas at risk of explosion (e.g. petrochemical plants, military ordnance bases, explosive and hazardous material manufacturing), Jarvie Plant Accommodation can provide Blast Rated units with:

Minimum 100mbar side-on overpressure

Minimum 200mbar reflected overpressure

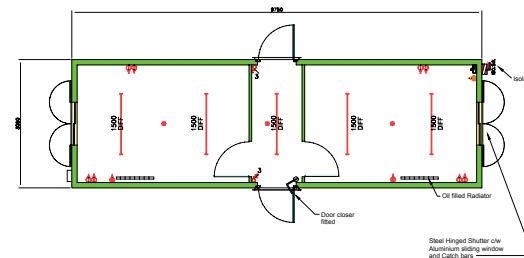
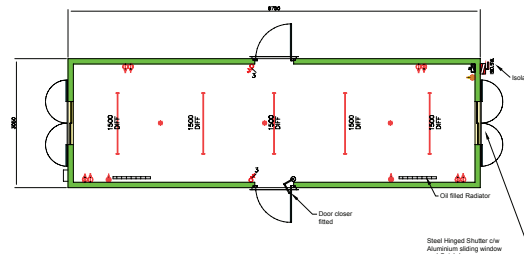
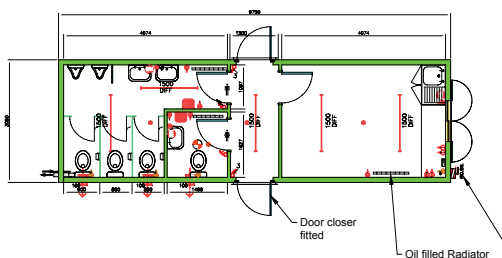

	32' Open Plan Office	32' Office, Corridor, Office
External Finish	Profiled Steel Panels	Profiled Steel Panels
External Doors	Steel Multipoint Locking c/w Closers	Steel Multipoint Locking c/w Closers
Windows	Single Pane Double Sliding Aluminium Framed c/w Toughened Laminated Glass	Single Pane Double Sliding Aluminium Framed c/w Toughened Laminated Glass
Insulation	80mm Cladding roll to Floors, Walls & Ceilings	80mm Cladding roll to Floors, Walls & Ceilings
Studwork	50mm Galv C Stud & Track throughout & Galv Ceiling System mechanically fixed to channel hangers	50mm Galv C Stud & Track throughout & Galv Ceiling System mechanically fixed to channel hangers
Floor Coverings	15mm Tag Plywood overlaid with Grey vinyl c/w welded seams	15mm Tag Plywood overlaid with Grey vinyl c/w welded seams
Walls	White Dolomite Vinyl faced plasterboard, white H Sections & White skirting.	White Dolomite Vinyl faced plasterboard, white H Sections & White skirting
Ceiling	White Dolomite Vinyl faced plasterboard	White Dolomite Vinyl faced plasterboard

NIGHT REST SLEEPER UNITS

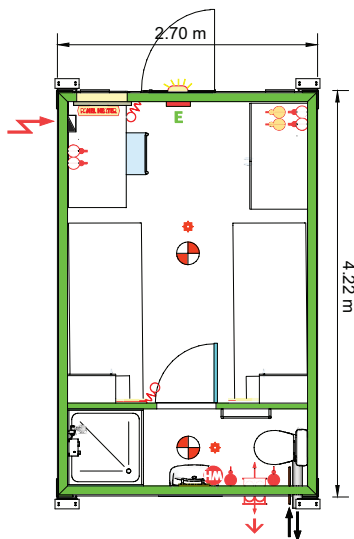

HSU 14' x 9' 'Night Rest' Sleeper Unit

Feature	Details
Dimensions	14ft x 9ft
Occupancy	Sleeps 2
Sleeping Arrangement	Two single beds
Sanitary Facilities	Toilet, wash basin, and shower
Kitchenette	Fridge, microwave, worktop
Storage	Wardrobe
Construction	Steel frame, insulated panels
Power Supply	Electrical hookup (site-dependent)
Lighting & Heating	Internal lighting & heating included
Use Case	On-site accommodation for construction and remote work



HSU 24' x 9' 'Night Rest' Sleeper Unit

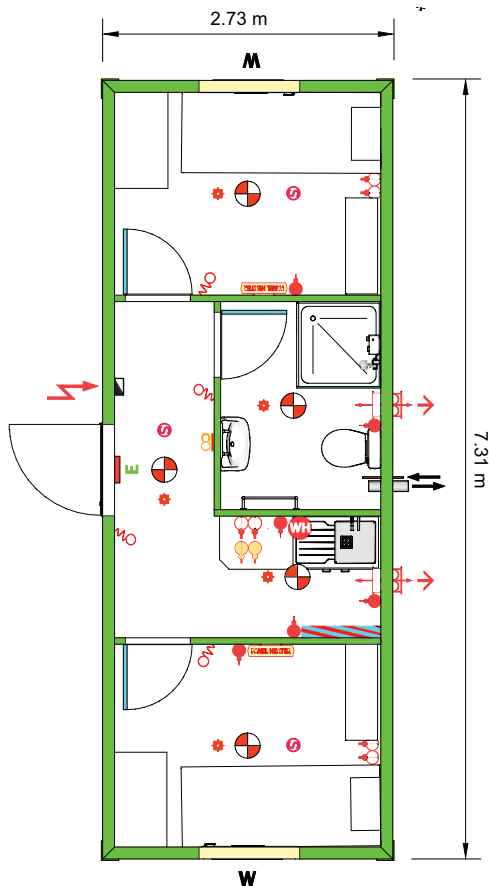

Feature	Details
Dimensions	24ft x 9ft
Occupancy	Sleeps 2
Sleeping Arrangement	Two single bedrooms
Sanitary Facilities	Toilet, wash basin, and shower
Kitchenette	Fridge, microwave, worktop
Storage	Wardrobes
Construction	Steel frame, insulated panels
Power Supply	Electrical hookup (site-dependent)
Lighting & Heating	Internal lighting & heating included
Use Case	Compact on-site accommodation for two workers

STORES



C039 Safestore - 8'



C040 Safestore - 10'



C041 Safestore - 20'



C042 Safestore - 30'



C043 Safestore - 32' x 10'

ANCILLARIES / ACCESSORIES

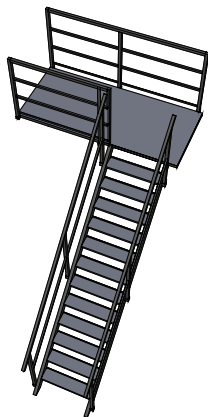
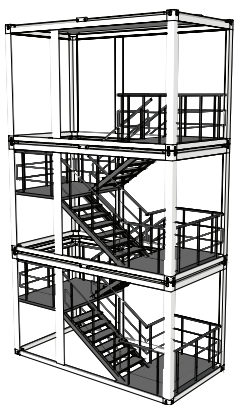

Smoking Shelters

Our smoking shelters are anti-vandal, all-steel, open-sided units with slip-resistant floors and ashtrays - ideal for safe, compliant site use.

Toilet Waste Tank & Mini Stairs

When no connection to mains sewerage is available we offer 4000 litre low-profile above ground waste tanks along with substantial steel stairs and platforms that allow safe access.

Our waste tanks are enclosed but vented and fitted with an audible warning indicating 3/4 full.

All our waste tanks are emptied on site to an agreed schedule or as required.

Furniture

Our site furniture includes durable canteen tables, chairs, lockers, and noticeboards - ideal for practical, organised, and comfortable site welfare.

Water Tank

Our auto-water units are designed to provide a reliable water supply for toilets and sinks, not drinking water, when mains water is not available.

We offer 1,000 litre and 3,000 litre compact steel units with a plastic water tank and a robust 240V pump which starts pumping automatically when water is called for.

A heater protects the pump in freezing weather and connections for water outlet and power supply are located conveniently on the outside.

All our water tanks are filled on site to an agreed schedule or as required.



Staircases for Stacking

All staircases are built with solid chequer plate with non-slip coating. As well as single access staircases we have gantry platforms to bridge between pairs of stacked units.

Services We Provide Include

Welfare Servicing

Chemical and water flush toilet; generators

Site Establishment

Stacking; linking; electric power connection and testing; water and waste tank connections.

Water and Waste Servicing

Refilling auto-water units; emptying toilet waste tanks and effluent disposal.

Site Support Services

We provide comprehensive delivery and assembly/ disassembly and uplift packages for individual units, site compounds and major projects. We back-up all our Accommodation Products on hire with a team of mobile field service fitters coordinated by our dedicated customer service staff.

JPX Modular Building Assembly

One, two and three storey; 30m² to over 1,000m²; crane installation; qualified and competent assembly teams; full project plan and risk assessed method statement following order.

Site Maintenance

Skilled trades people; all trades; appropriate response time; urgent requirements same day/next day; 4 hour response and out of hours response to welfare generators available; risk-assessed and safe systems of work.

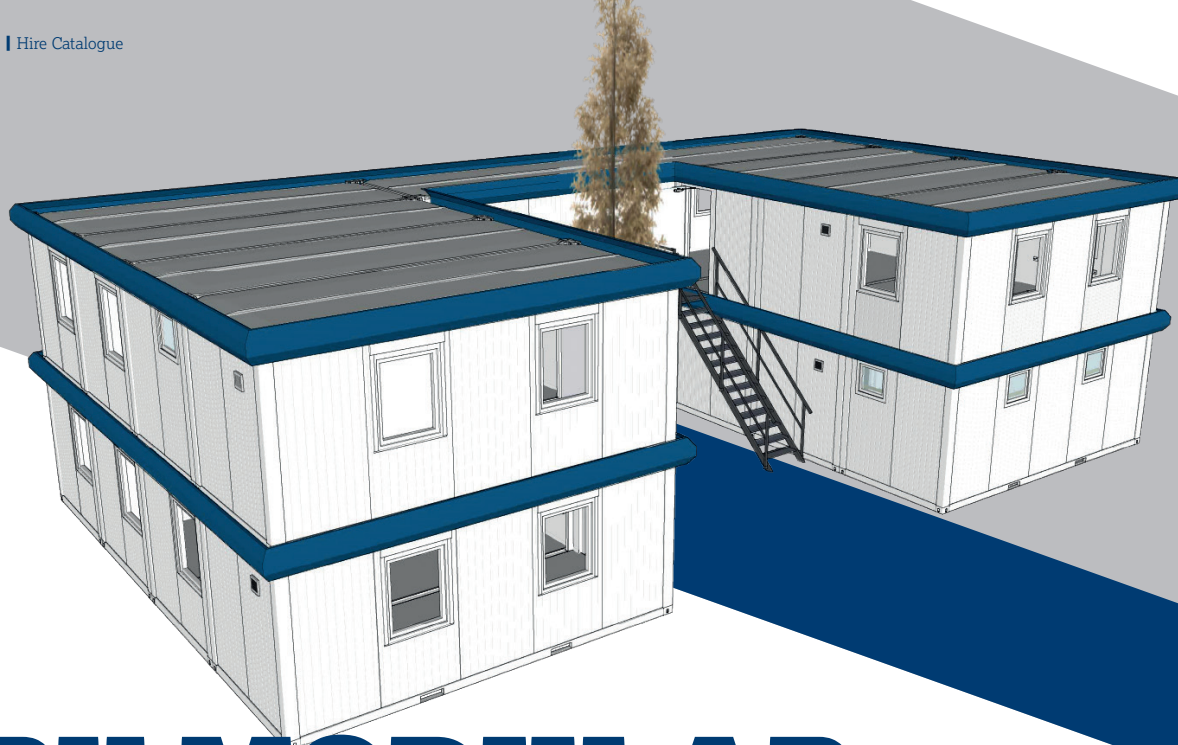

JPX MODULAR BUILDINGS

JPX Modular Buildings provide a flexible modular system and high standard of accommodation including double glazing as standard. Prime specification which includes PIR controlled lighting, timed heating, push taps to hot and cold and self-closers to exterior doors is available.

We can provide very large buildings for major projects or small buildings to fit in sites where space is at a premium. Our modular system is able to utilise every square foot available and turn it into usable accommodation.

From your brief we will design a layout with open plan and individual offices, meeting rooms, kitchen and toilets;

welfare with canteen, drying rooms, toilets, showers, induction room, and first aid room and we will refine designs as required.

Bespoke buildings configured to closely meet your requirements can be achieved efficiently and cost effectively.

The JPX System offers excellent Sales Suites with the potential of high quality, spacious reception and display areas integrated with smaller private areas and customer facilities, while our special glazing and fascia features attract attention.



Stacked steel calm - JPX 4on4:



JPX 8on8



4x4 JPX Modular Building

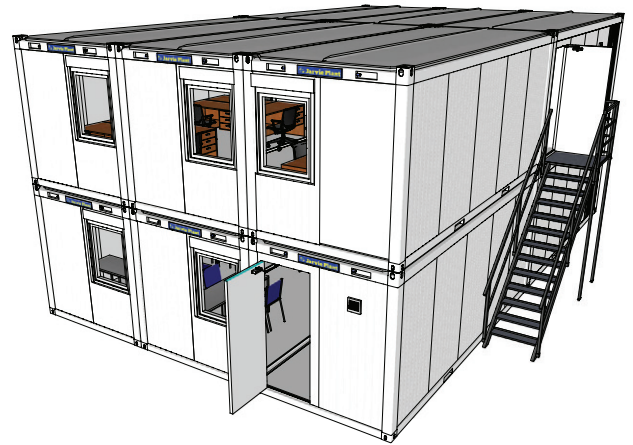

6x6 JPX Modular Building

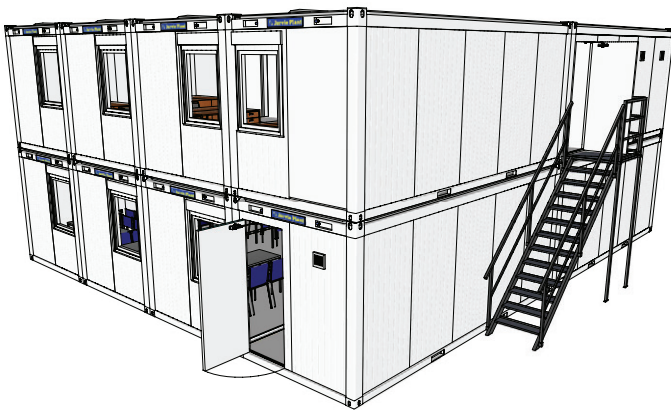

8x8 JPX Modular Building

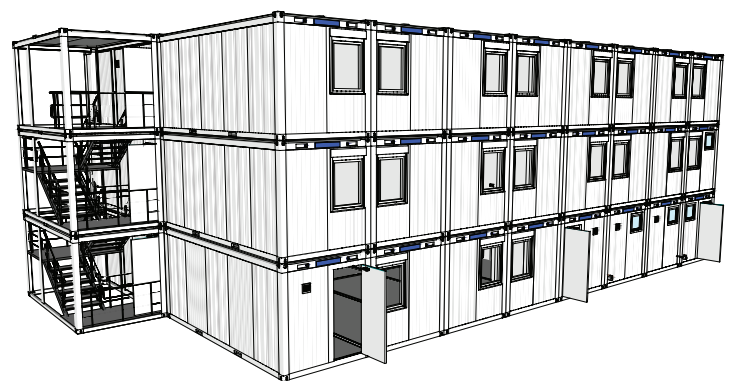

3 Storey JPX Building

LESS FUEL MORE PROFIT



FOR MORE INFORMATION

MOLSON
Young Plant Sales

01179 820 123

info@molsongroup.co.uk

molsongroup.co.uk

Molson Group Ltd, Smoke Lane, Avonmouth,
Bristol BS11 0YA



VEHICLES

At JP Vehicle Rentals we draw on our membership of the Jarvie Group to deliver outstanding service. No matter your requirements we have the right vehicle for you at the right time. From a 'Group A' small hatchback car to a 'Group F' people carrier, from a four wheel drive double-cab pick-up to a Luton van with tail-lift, all are readily available from our extensive fleet depot wide.

We offer a full range of cars, people carriers and mini buses to suit any budget. Our light commercial vehicles are available up to 3.5 GVW. Our cars and light commercial vehicle are available for business or retail hire. All vehicles can be placed on short and long-term hire contracts.



Mini Car



Small Car



Medium Car



Large Car



People Carrier



Sports Utility Vehicle

Our extensive fleet of cars gives you the choice of vehicle to suit your needs. With a large selection of vehicle available from all our depot locations we're on hand to get you on the move.

CARS

CODE	CARS-A	CARS-B	CARS-C	CARS-D	CARS-F
Description	Small Car	Economy Car	Compact Family Car	Standard Size Car	People Carrier
Features & Options	3 Door	5 Door, air-conditioning, bluetooth	Automatic available, air-conditioning, bluetooth	Auto available, air-conditioning, Sat Nav and bluetooth	Sat NAV

CODE	CARS-G
Description	Sports Utility Vehicle
Features & Options	Sat Nav and 4WD available



BUS-0010
9 Seat Minibus

Our fleet of minibuses are bigger, more comfortable and versatile for your needs. Standard safety features include curve control, traction control system, hill start assist, emergency brake assist (EBA) and roll stability control (RSC).

The diesel engines are fuel efficient and have low CO2 emissions. We have 9-17 seat vehicles for hire on long and short-term hire.



BUS-0050
17 Seat Minibus

BUSES

CODE	BUS-0010	BUS-0030	BUS-0050
Description	9 Seat Minibus	12 Seat Minibus	17 Seat Minibus
Features & Options	Sat Nav, M1 specification seats, standard driving licence	Overhead storage shelves with individual air conditioning vents and LED lights. Reclining seats with armrests	Overhead storage shelves with individual air conditioning vents and LED lights. Reclining seats with armrests



PICK-0050
3.5 Tonne GVW Single Cab Tipper



PICK-0030
4WD Double Cab Pickup



PICK-0020
4WD Pickup

Our pick-ups are available with a single or double cab and tail lifts.

PICKUPS

CODE	PICK-0020	PICK-0030	PICK-0040	PICK-0050	PICK-0070	PICK-0080
Description	4WD Pickup	4WD Double Cab Pickup	3.5 Tonne GVW Pickup	3.5 Tonne GVW Tipper	3.5 Tonne GVW Crew Cab Tipper	3.5 Tonne GVW Pickup with Tail Lift
Optional Extras	Towbar, beacon	Truckman top, towbar, beacon	Towbar, beacon	Towbar, beacon	Towbar, beacon, refuse cage	500kg Tail Lift, beacon



VANS-0020
Cube Van



VANS-0060
LWB Van



VANS-0040
Small Crew Van



Welfare Van

We have a full range of light commercial vehicles up to 3.5 GVW. Whether you need a small van for transporting small loads or a large Luton van to move large loads we have a vehicle to suit your needs.

VANS

CODE	VANS-0020	VANS-0030	VANS-0040	VANS-0045	VANS-0050	VANS-0055
Description	Cube Van	3 Seats Cube Van	5 Seat Van	750kg Van	1 Tonne Panel Van	Crew Van
Optional Extras	Beacon load up to 850kg, side door	Beacon, 3 front seats, hold a Euro pallet	Beacon with or without windows. Seats fold to increase load space	Beacon, twin side doors, rear view camera	Towbar, beacon, bluetooth	6 seats, towbar, beacon, Bluetooth and Sat Nav

CODE	VANS-0058	VANS-0060	VANS-0065	VANS-0080	VWEL7
Description	2.9 Tonne LWB Panel Van	3.5 Tonne LWB Panel Van	3.5 Tonne Jumbo Van	3.5 Tonne Luton with Tail Lift	Welfare Van - 7 seats
Optional Extras	Towbar, beacon	Towbar, beacon	Towbar, beacon	500kg tail lift	-

Our Welfare Vans are ideal for when you need mobile facilities for your workers. Whether its at the roadside or a remote site our vehicles have all the amenities you need. All our welfare vans are constructed to M1 specification.

- ✓ Comply with all current health and safety and European Community Whole Vehicle Type Approval.
- ✓ ECWTA ensures 'All vehicles are safe to use on the road and have a lower impact on the environment'.
- ✓ Six passenger seats, driver seat, kitchen, toilet and hand basin.
- ✓ Supplied with a fridge and microwave oven.
- ✓ Heat and hot water provided by an independent heating system.
- ✓ Wrist to elbow wash hand basin fitted in the rear toilet compartment.
- ✓ Toilet area fully heated so the crew can dry their clothes.
- ✓ Van is powered by two deep cycle batteries through an inverter.
- ✓ Battery guard fitted to ensure batteries are not drained below starting voltage.
- ✓ Additional toilet cartridges are available as a consumer item.

TERMS & CONDITIONS

SPECIFIC TO VEHICLE HIRE

1. YOUR CONTRACT WITH US

When you sign the form on page 1 of this rental agreement, you accept the conditions set out in this rental agreement. Please read this agreement carefully. If there is anything you do not understand, ask a member of staff to explain it.

2. RENTAL PERIOD

You will have the vehicle for the period shown in the agreement. If you do not bring back the vehicle on time, you will be breaking the conditions of this agreement. We can charge you for every day or part of the day you have the vehicle after you should have returned it to us. We will charge you a daily or hourly rate (which will be shown at the place you have rented the vehicle from) until we get our vehicle back.

If you break our agreement, we can ask you to bring back the vehicle before the date and time we have agreed with you. To do this we will give you written notice in person or send it to the address you have given on. Once we have given you the notice in person, you will no longer have our permission to have the vehicle. If we send you a notice in the post, one day after we have posted it you will no longer have our permission to have the vehicle. We may then take back our vehicle. If we believe you have given us false information, we may take back the vehicle without giving you any notice.

3. YOUR RESPONSIBILITIES

(a) You must inspect the vehicle and any accessories we provide before you take the vehicle. If you are not satisfied with the vehicle or you do not think the condition of the vehicle meets our pre-rental inspection report, you should let us know.

(b) You must look after the vehicle, any accessories and the keys or other locking device for the vehicle. You must always lock the vehicle when you are not using it, and use any security device which is fitted or which we supply. You must always protect the vehicle against weather conditions which could cause damage. You must make sure that you use the correct type of fuel and fluids in the vehicle.

(c) Depending on section 8 of this agreement ('Our motor insurance and damage protection programme'), you are responsible for any damage to the vehicle, including damage caused by hitting low-level objects such as bridges or low-hanging tree branches. You will have to pay our reasonable costs for bringing the vehicle back to the condition stated in the pre-rental inspection report. This could include the cost of any damage inside and outside the vehicle, cleaning costs if the vehicle is very dirty, and replacing any items or accessories.

(d) You must not sell, rent or get rid of the vehicle or any of its parts. You must not give or try to give anyone the legal rights to the vehicle or transfer legal ownership.

(e) You must not let anyone work on the vehicle without our permission. If we do give you permission, we will only give you a refund if you have a receipt for the work we have given you permission for.

(f) You must let us know as soon as you become aware of a fault with the vehicle, or if the vehicle is stolen or involved in an accident.

(g) If we have agreed to drop off the vehicle at an address you give us, you will be responsible for the vehicle from the time we drop it off.

(h) Unless we have agreed to collect the vehicle from you must return the vehicle to the location or rental branch we agreed. You must return it during the opening hours or at a time we tell you. When you return the vehicle, our staff must check its condition. If we have agreed to allow you to return the vehicle outside of our opening hours, you will stay responsible for the vehicle and its condition until our staff have checked it. We may need to clean the vehicle before our staff can check its condition.

(i) You must not carry any object or substance which, because of its condition or smell, may harm the vehicle or delay us renting or selling it.

4. OUR RESPONSIBILITIES

(a) We will identify and tell you about any existing damage to the vehicle before you sign this agreement.

(b) We have maintained the vehicle to at least the manufacturer's recommended standard. The vehicle is roadworthy and suitable for you to use at the start of the rental period.

(c) We are responsible if someone is injured or dies as a result of our action or failure to act. We are also responsible for any loss you suffer as a result of us breaking this agreement, if we could have predicted your loss at the time this agreement started and it is a result of us breaking this agreement. We are not responsible for any loss which is a side effect of the main loss and which we or you could not have predicted, such as loss of profits or loss of opportunity (for example not being able to go to a business meeting).

TERMS & CONDITIONS

SPECIFIC TO VEHICLE HIRE

5. PROPERTY

We are only responsible for loss or damage to property in the vehicle if the loss or damage is a result of our neglect or if we have broken the conditions of our agreement. You are responsible for removing your personal belongings from the vehicle at the end of the rental period, as we are not responsible for any items you leave in the vehicle. If you do leave items in the vehicle, we may agree to keep them for you to collect within a reasonable time. We may charge you reasonable costs for storing the items.

6. CONDITIONS FOR USING THE VEHICLE

(a) Only you, any driver named on and anyone we have given written permission to, can drive the vehicle. Anyone driving the vehicle must have a full driving licence which is valid in the European Economic Area for the type of vehicle you are renting.

(b) You must not rent the vehicle to anyone else. You must also not use the vehicle or let someone else use it:

(b1) for any illegal purposes or in a way which would cause nuisance;

(b2) to carry passengers for a fee (except for minibuses which you have a valid operator's licence for);

(b3) for driving lessons;

(b4) to tow or push any vehicle, trailer or other object, without our written permission;

(b5) for racing, pacemaking, or to test the vehicle's reliability or speed;

(b6) off roads or on roads unsuitable for the vehicle;

(b7) if the driver has been drinking alcohol or taking drugs;

(b8) outside the United Kingdom, unless we have given you written permission and a Vehicle on Hire Certificate;

(b9) if it is loaded beyond the manufacturer's maximum weight recommendations;

(b10) to carry unsecured loads;

(b11) to carry more passengers than the vehicle was manufactured to legally carry; or

(b12) if the driver does not have a valid operator's licence (if it is a goods vehicle or a minibus).

7. CHARGES

We work out our charges using our current price list, which includes VAT. You will be responsible for paying the following charges.

(a) The rental and any other charges we work out according to this agreement.

(b) Any charge for loss or damage resulting from you not keeping to your responsibilities, as set out in section 3 (above).

(c) A refuelling service charge if you did not return the vehicle to us with the agreed amount of fuel. The charge will be based on the rates set out on page 1 of this agreement or those at the location or rental branch you rented the vehicle from (or both).

(d) All charges and legal costs for any congestion charge, road-traffic offence or parking offence, or any other offence involving the rental vehicle, including costs from the vehicle being clamped, seized or towed away. You are responsible for paying the appropriate authority or company for any charges and costs if and when they ask for these payments. You will also be responsible for paying our reasonable administration charges for dealing with these matters.

(e) The reasonable cost of repairing any damage to the vehicle which was not noted at the start of the agreement, whether you were at fault or not (depending on section)

4. You will also be responsible for paying the reasonable cost of replacing the vehicle if it is stolen or written off, depending on any insurance you have (as set out in section 8), if and when we demand this payment.

(f) A loss-of-income charge, when we demand it, if we cannot rent out the vehicle because it needs to be repaired, if it is a write-off (it cannot be repaired), or if it has been stolen and we are waiting to receive a full payment of the vehicle's value.

(g) We will only charge you for loss of income if we cannot get back our losses under the damage protection programme, as explained in section 8. We will charge you at the published daily or hourly rate, and we will never charge you for more than 30 days. We will always do everything we can to make sure we repair the vehicle or get back our costs as soon as possible.

TERMS & CONDITIONS

SPECIFIC TO VEHICLE HIRE

(h) Any recovery charges arising from the Driver and Vehicle Standards Agency (DVSA), HM Revenue & Customs (HMRC), the police, or any other public organisation (or their agent) who has seized the vehicle. You will also have to pay us a loss-of-income charge while we cannot rent out the vehicle.

(i) Any published rates for delivering and collecting the vehicle, a charge for an extra driver or returning the vehicle late, and charges for accessories such as child car seats, satellite navigation systems and other similar items.

(j) Interest, which we will add every day to any amount you do not pay us on time, at the rate of 4% a year above the base lending rate as published by Barclays Bank. We will publish this rate from time to time.

(k) We will work out all charges in line with this agreement, and they will include VAT (if this applies). You are responsible for all charges, even if you have asked someone else to be responsible for them.

8. OUR MOTOR INSURANCE AND DAMAGE PROTECTION PROGRAMME

You can get full details of our damage protection programme from the office at which you rented the vehicle. If we arrange separate motor insurance, we will give you information on the motor insurance cover and any restrictions which may apply. Otherwise, the conditions of our motor insurance and damage protection programme will apply. By putting your initials in the appropriate box on of the rental agreement, you are accepting the conditions of our motor insurance and damage protection programme.

(a) We have a legal responsibility to have third-party motor insurance. This provides cover for claims if you injure or kill anybody, or damage their property. Cover for damage to property is limited to £1 million.

(b) We will provide cover for loss or damage to the vehicle if you have put your initials in the box marked 'Collision and loss damage waiver'. Even if you accept this, you still have to pay an amount up to the 'responsibility amount' every time you damage the vehicle. The responsibility amount you have to pay in each case is shown on page 1 [of the rental agreement].

(c) We will provide cover for theft and damage to the vehicle caused during a theft or attempted theft if you have put your initials in the box marked 'Theft waiver' of the rental agreement. Even if you accept this, you still have to pay an amount up to the 'responsibility amount' if the vehicle is stolen.

(d) We will, if available, provide personal accident insurance, personal belongings insurance and goods-in-transit insurance if you have put your initials in the appropriate boxes on the rental agreement. You are

responsible for deciding whether these products are suitable for your needs. We are not responsible if the product does not meet your needs.

9. YOUR OWN INSURANCE

If we fill in the appropriate box on of the rental agreement, you may arrange your own motor insurance to cover your legal responsibility for any loss, or if the vehicle is stolen or damaged, for the full period you are renting the vehicle for. You must prove that this motor insurance is valid and sign the confirmation on of the rental agreement.

We have the right to agree:

- The amount of cover you arrange;
- The type of policy you choose; and
- The insurer you choose.

We must be satisfied with the insurance cover and policy conditions, and you must not change them. We may ask your insurers to record our name as owner of the vehicle. If the vehicle is damaged or stolen we will negotiate any settlement for loss or damage with your insurers, and we will receive any money they pay out. This includes allowing us to take legal action in your name and defending any proceedings taken against you. You are responsible for paying the full claim and paying all costs if the policy you have arranged fails and the vehicle is damaged, lost or stolen, or someone else makes a claim.

10. WHAT TO DO IF YOU HAVE AN ACCIDENT OR THE VEHICLE IS STOLEN

If you are involved in an accident, you must not admit that you are responsible. You should describe the situation as fully as possible when you are asked to do so by the police and us. You should get the names and addresses of everyone involved, including witnesses. You should also:

(a) make sure the vehicle is secure;

(b) tell the police straight away if anyone is injured or if on of the rental agreement. If the vehicle has been stolen, you must tell us as soon as possible and confirm this in writing as soon as reasonably possible. You or any authorised drivers will also need to:

- Get the names and addresses of any witnesses and give them to us;
- Send us any notices or other documents relating to any legal proceedings arising out of the theft or loss;

TERMS & CONDITIONS

SPECIFIC TO VEHICLE HIRE

- Help us and our insurers in any legal proceedings, including allowing us to take legal action in your name and defending any legal action taken against you; and
- Give us back all keys and report the theft or loss to the police as soon as reasonably possible.

11 DATA PROTECTION

By entering into this rental agreement you agree that we can process and store your personal information in connection with this agreement. We will use your information to analyse statistics, or market research, credit control and to protect our assets.

You agree that if you break the terms of this agreement we can pass your personal information to credit-reference agencies, debt collectors, the police or any other relevant organisation. We can also give this information to the British Vehicle Rental and Leasing Association (BVRLA), which can share your personal information with its members to prevent crime and protect its assets, as allowed under the Data Protection Act 1998.

12 ENDING THIS AGREEMENT

(a) We will end this agreement if we find out that your belongings have been taken away from you to pay off your debts, or a receiving order has been made against you. We may end this agreement if you do not meet its main conditions.

(b) If you are a company, we will end this agreement if: You go into liquidation; You call a meeting of creditors; We find out that your goods have been taken away from you until you pay off your debts; or you do not meet any of the conditions of this agreement.

(c) If we end this agreement it will not affect our right to receive any amount you owe us under the conditions of this agreement. We can also claim reasonable costs from you if you do not meet the main conditions of this agreement. We can repossess the vehicle and charge you a reasonable amount for doing so.

13 THE LAW

We aim to deal with all disagreements fairly and calmly. If we cannot deal with a disagreement, we may take the matter to the BVRLA's conciliation service. This agreement is governed by the laws of the country in which you signed it. Any disagreement may be settled in the courts of that country. This agreement contains all the conditions which we have agreed and replaces any written or verbal agreements we have with you.

HIRING WITH CONFIDENCE

All invoices are payable in advance for the agreed period plus a deposit except where a credit account has been approved when invoices are then payable at the end of the month following date of invoice or when the credit limit is exceeded whichever is first. Charges will automatically be made to credit cards if the hire continues over two weeks or if the continuing hire charge exceeds the deposit. Sales are payable on delivery. Title to all good sold remains with Jarvie Plant Group Limited until paid for in full.

IMPORTANT: AN 'OFF HIRE NO.' OR A RECEIPT MUST BE OBTAINED BY THE HIRER TO CONFIRM ALL OFF HIRE INSTRUCTIONS.

All plant and accommodation hired is transacted under SPOA conditions of hire. Full conditions are available on request and on the reverse of delivery tickets. A summary of these conditions are listed below.

- (a) Hire rates are based on a 5 day, 40 hour week. Excess hours are charged pro-rata.
- (b) Hire charges commence on the day the plant leaves our depot and terminate on the day it is returned. Each of these days is charged as a full day.
- (c) There is a minimum hire charge for Plant:
 - a. One day = 50% of the weekly rate
 - b. Two days = 60% of the weekly rate
 - c. Three days = 80% of the weekly rate
 - d. Four days + = 100% of the weekly rate
 - e. Accommodation 200% of the weekly rate. Thereafter each day is charged at 20% of the weekly rate. Please refer to our current price list for details and rates.
- (d) The hirer is responsible for daily maintenance of the plant including the supply of fuel, oil, grease etc.
- (e) Any faults or breakdown must be notified immediately.
- (f) Consumables will be charged at start of hire and sharpening of steel and fuel used will be charged on completion of the hire.
- (g) The hirer is responsible for loss of or damage to the plant for any reason whatsoever until received by us and a receipt obtained and should arrange suitable insurance to cover this risk.
- (h) All damage to tyres and tubes is the responsibility of the hirer and repairs carried out are at the hirer's expense.

(i) Transport to and from site is extra. All vehicle rentals are transacted under BVRLA conditions of hire. Refer to deliver advice for details.

(a) All use is restricted to mainland UK

(b) Excess mileage will be charged as per our standard list price. Daily rates include 150 miles. Weekly rates include 600 miles.

(c) Congestion charges and road traffic fines not paid by the hirer will be paid by JP Vehicle Rentals Ltd and re-invoiced to the customer at cost plus £20 per offence. Additional expenses incurred in recovering overdue accounts will be payable. This includes court expenses, statutory interest at bank rate + 8%, compensation on all late payments and bank charges for returned cheques. It is agreed sums invoiced become due for payment immediately if terms of payment are not honoured.*

(Ref: Late Payment of Commercial Debts Interest Act 1998 as amended and supplemented by the Commercial Debts Regulation 2002)*

* SPOA - Applies to Plant. BVRLA - Applies to Vehicle

GENERAL CONDITIONS OF HIRE

1. DEFINITIONS

(a) In these Conditions:-

“Delivery” means when the Plant is uplifted by the Hirer from the Owner’s depot or delivered to the Hirer’s site or other delivery location agreed between the Owner and the Hirer.

“Hire Charges” means the various charges detailed in Condition 12.

“Hirer” means the person, firm or company taking the Plant on hire, including their successors, representatives and agents.

“Off Hire Number” means a unique number provided by the Owner confirming that the Hirer is no longer responsible for meeting Hire Charges.

“Owner” means the person, firm or company letting out the Plant on hire and includes their successors and assignees.

“Period of Hire” means from the time of commencement until the time of expiry of the period of hire as defined by Condition 3.

“Plant” means any machine, equipment or part of them which the Owner agrees to hire to the Hirer in accordance with these Conditions.

“SPOA” means the Scottish Plant Owners Association.

“Standing Time” means the time during which the Plant supplied with an operator is standing idle and available for work.

“Working Week” means from start of business on a Monday until close of business on the following Friday.

(b) In these Conditions words importing the singular shall include the plural and vice versa and any gender includes any other gender and the neuter.

2. GENERAL

(a) These Conditions shall be incorporated into and shall govern each contract (“the Contract”) for the hire of Plant entered into between the Owner and the Hirer to the exclusion of any terms or conditions of the Hirer. No variation of any of these Conditions shall be effective unless in writing and signed by an authorised representative of the Owner. If the Hirer’s order attempts to exclude these Conditions, such exclusion shall be ineffective unless expressly agreed to in writing by an authorised representative of the Owner.

(b) Nothing in these Conditions shall exclude or limit any statutory rights of the Hirer which may not be excluded or limited due to the Hirer acting as a consumer. Any provision which would be void under any consumer protection legislation shall, to that extent, have no force or effect.

3. PERIOD OF HIRE

(a) In these Conditions, unless the context otherwise requires, the time of commencement of the Period of Hire is:-

(i) in a case where the Plant is collected by the Hirer from the Owner’s depot or elsewhere, the time it is so collected;

(ii) in a case where the Plant comes under the control or direction of the Hirer or his agent before arrival at the Hirer’s site, the time it becomes subject to such control or direction; or

(iii) in all other cases, the time the Plant arrives at the Hirer’s site.

(b) In these Conditions, unless the context otherwise requires, the time of expiry of the Period of Hire is:-

(i) in a case where the Plant is returned by the Hirer to the Owner’s depot or to such other destination as may be directed by the Owner, the time of its arrival there; or

(ii) in a case where the Plant comes under the control and direction of the Owner after leaving the Hirer’s site but before arriving at the Owner’s depot or such other destination as may be directed by the Owner, the time it becomes subject to the Owner’s control or direction.

4. OWNERSHIP

(a) The Plant shall remain the property of the Owner at all times.

(b) Subject to these Conditions, risk in, and liability for loss or damage to, Plant supplied by the Owner to the Hirer shall pass to the Hirer at the time of commencement of the Period of Hire.

5. NOTIFICATION OF DEFECTS, SAFE KEEPING OF PLANT

(a) **NOTIFICATION OF DEFECTS.** The Hirer or his representative shall inspect the Plant on Delivery. The Plant shall be deemed to be in good order (save for latent defects and defects not reasonably ascertainable by inspection) and no claim for loss and damage shall be considered by the Owner unless the Hirer gives written notice to the Owner of an alleged defect within 24 hours of delivery.

(b) **SAFE KEEPING OF PLANT.** The Hirer or his representative shall until the time of expiry of the Period of Hire keep himself acquainted with the state, condition and use of the Plant, ensure its safekeeping, and use it in a workmanlike manner only and not for any purpose beyond its capacity nor in any way likely to result in undue deterioration. If the Plant is stolen, the Hirer will report the theft to the police and supply a detailed description of the Plant to assist in its recovery.

(c) **VANDALISM.** Without prejudice to (b) hereof, the Hirer will be responsible to the Owner for destruction of or damage to the Plant caused maliciously or mischievously by any party whilst it is in his care or under his control. Destruction of or damage to Plant will be presumed to have been caused maliciously or mischievously and the onus of rebutting that presumption will be on the Hirer.

(d) On expiry of the hire the Hirer shall be responsible for returning the Plant to the Owner or allowing the Owner access to uplift it, whichever is agreed between the Owner and the Hirer, in the same condition as on Delivery (fair wear and tear excepted).

GENERAL CONDITIONS OF HIRE

6. BREAKDOWN

(a) Except as otherwise provided in Condition 5(a), any breakdown or unsatisfactory working of Plant must be notified to the Owner within 24 hours of its discovery by the Hirer or his representative. Breakdown time claims will only be considered from the time of notification. In default of such notification the Owner shall be deemed to have properly performed its obligations under the Contract. In the event of a breakdown or unsatisfactory working of Plant, not readily repairable, the Owner shall be entitled to supply substitution Plant of a similar type and condition. If the Owner is not in a position to do so, the Contract shall be terminated as from the date of the breakdown.

(b) The breakdown or stoppage of any one item of Plant shall not entitle the Hirer to claim any compensation or allowance for the loss of working time by any other item of Plant working in conjunction with it.

(c) Each unit of Plant specified in the Contract is hired as a separate item unless expressly hired together with other unit(s) of Plant as a single composite item.

7. ALLOWANCES

(a) Provided notification has been made to the Owner in accordance with these Conditions, the Hirer will not be charged for any stoppages for normal working repairs or due to breakdown of Plant caused by an inherent fault or fair wear and tear. The Hirer's only remedy for such stoppages shall be an allowance up to the amount of Hire Charges otherwise due.

(b) No allowance will be made for stoppages resulting from any other cause for which the Owner is not responsible (including bad weather and ground conditions).

8. SERVICING AND INSPECTION

(a) The Hirer shall allow the Owner, his representatives or insurers access to the Plant at all reasonable times for the purposes of inspecting, testing, adjusting, repairing or replacing it.

9. HIRER'S RESPONSIBILITIES

(a) Except as otherwise provided in Conditions 5 & 6, the Hirer shall reimburse the Owner for all loss or damage to the Plant (fair wear and tear excepted) during the Period of Hire whether or not caused by fault on the part of the Hirer and shall indemnify the Owner in respect of all claims by third parties for any loss, injury or damage arising out of the storage, transit, transport, unloading, loading, erecting, dismantling and/or use of the Plant and all associated costs and charges.

(b) During the Period of Hire the Hirer shall insure the Plant at the Hirer's own expense against loss and damage from all risks (including third party risks) and indemnify the Owner against all loss or damage to the Plant not recoverable under the policy of insurance.

(c) The Hirer shall, in the event of loss of or damage to the Plant howsoever caused, be liable for the Hire Charges until the Hirer pays for the cost incurred by the Owner in respect of such loss and damage.

(d) If the Plant is involved in any accident resulting in injury to persons or damage to property, immediate notice must be given to the Owner by telephone and confirmed in writing to the Owner.

(e) The Hirer shall be responsible for the cost of the changing and repair of any tyre punctures and shall arrange for the tyre(s) to be repaired or replaced without awaiting the Owner's consent. The Hirer shall ensure that all replacement tyres meets the manufacturer's recommended specification and that all repairs are carried out to the highest standard of workmanship.

(f) If the ground (including any private access road or track) is soft or unsuitable for the Plant to work on, travel, or be transported over (including for delivery and collection) without suitable timbers or equivalents, the Hirer shall supply and lay suitable timbers or equivalents in a suitable position.

(g) The Hirer shall be responsible for the unobstructed access to, and (unless otherwise agreed in writing) loading, unloading, erecting and/or dismantling of the Plant at the Hirer's site. Any personnel supplied by the Owner for such work at the Hirer's site shall be deemed to be under the direction and control of the Hirer who shall be responsible for all claims arising out of the work

10. INDEMNITY TO OWNER

Where an operator is provided with the Plant, he shall work under the supervision and instructions of the Hirer or his representative who shall not permit any person other than the operator to operate the Plant without the Owner's prior written consent. During the Period of Hire the Hirer shall be responsible for the operator's actions as if he were in the Hirer's direct employ to the effect that the Hirer shall free and relieve the Owner of and from the consequences of all claims made against the Owner by (a) third parties as a consequence of any acts or omissions of the operator, including negligence or breach of statutory duty; and/or (b) the operator in respect of any loss injury or damage suffered by him except where that loss injury or damage arises as a consequence of any negligence of the Owner.

11. PROTECTION OF OWNER'S RIGHTS

(a) The Hirer shall not sell, sub-let, hire, assign, grant security over, deal with or part with possession or control of the Plant, or attempt to do so without the Owner's prior consent in writing.

(b) The Hirer shall not remove, deface or cover up the Owner's nameplate or mark on the Plant indicating that it is the Owner's property.

(c) Except as provided for by Condition 9(e), the Hirer shall not repair or adjust the Plant or attempt to do so unless authorised by the Owner in writing.

12. CHARGES

- (a) (1) Where the Plant is hired at a rate per Working Week the charge is based on a maximum of 39 hours per Working Week unless otherwise stated (Hours worked in excess of that maximum shall be charged pro-rata);
- (2) Where the Plant is hired on a basis of a rate per day the charge is based on a maximum of eight hours per day (except Friday which shall be seven hours) unless otherwise stated (Hours worked in excess of that maximum shall be charged pro-rata); and
- (3) Where the Plant is hired with an operator on the basis of a composite rate per Working Week or per day of a minimum or specified number of hours, any time for which it is working in excess of those hours shall be paid for pro-rata, the hourly rate being calculated by dividing the weekly rate or daily rate by the number of specified hours.
- (b) Overtime. When Plant is hired with an operator on the basis of separate Plant and operator rates, overtime shall be charged for hours worked in excess of the maximum or specified hours at the agreed Plant and operator rates plus the operator's premium overtime rates as applicable.
- (c) Standing Time. Where Standing Time is charged for it shall be at two thirds of the Plant rate plus the operator at his standard rate or at two thirds of any composite rate which has been charged for Plant and operator. In computing Standing Time, periods of shorter duration than those for which the rates are quoted shall be treated as working time. A standing period of less than a Working Week shall be treated as working time in the case of items of Plant being hired for a week of a specified number of hours and, in any event, a standing period of less than one day shall be treated as working time.
- (d) Assembling, Rigging and Dismantling. Time spent in assembling, rigging and dismantling Plant shall be charged to the Hirer.
- (e) Other Costs
- (i) Where the Plant is hired at a rate per Working Week the charge is based on a maximum of 39 hours per Working Week unless otherwise stated (Hours worked in excess of that maximum shall be charged pro-rata);
- (ii) Any consumable item, such as fuel, oil, AdBlue or grease supplied by the Owner shall be charged to the Hirer. It shall be the Hirer's responsibility, if purchasing such consumable items, to purchase items of good quality and which meet the appropriate specification for the Plant.
- (iii) Where appropriate, the cost of sharpening drills/steels etc shall be borne by the Hirer.
- (iv) The Hirer shall pay the costs of transport of the Plant from the Owner's depot or equivalent to the Hirer's site or other delivery location and also return to the Owner's depot or equivalent on expiry of the Period of Hire.

(v) The Hirer shall be responsible for the cost or expense of recovering any Plant from soft ground.

(vi) If using duty rebated fuel (like Red Diesel) the Hirer shall drain the tank of such fuel at the end of the Period of Hire and, if there is failure to do so, the cost of the Owner draining the tank and replenishing with duty paid fuel shall be charged to the Hirer at the minimum rate of one hours labour plus fuel used.

13. DETERMINATION OF RESPONSIBILITY FOR HIRE CHARGES

- (a) The Hire Charges shall run from the time of commencement of the Period of Hire until:-
- (i) Where the hire is for a fixed period, the expiry of that fixed period;
- (ii) Where the hire is not for a fixed period, or where the hire is continued after the expiry of the fixed period without any new period being determined, two days after either party shall have given to the other written notice to terminate the hire; or
- (iii) in any event, when the Hirer receives from the Owner a valid Off Hire Number in respect of the Plant; when the Hirer shall forthwith deliver the Plant to, or allow its uplift by, the Owner. Failure to do so will result in the Hirer being liable for the Hire Charges in respect of any period where there is delay in delivery or uplift which is not due to any act or omission of the Owner.

14. TERMINATION

- (a) If the Hirer:-
- (i) fails to pay any Hire Charges or other sums payable under the Contract when they become due (whether demanded or not);
- (ii) commits a breach of any other terms and conditions of the Contract; or
- (iii) shall do or allow to be done any act or thing which in the opinion of the Owner may jeopardise the Owner's rights in the Plant, then the Owner shall, without prejudice to any other right or remedy, have the right to automatically terminate the Contract without notice and without liability to the Hirer.
- (b) If any of the following events occur:-
- (i) the Hirer makes any voluntary arrangement with his creditors or (being an individual) shall die or (being an individual or firm) becomes bankrupt or (being a company) becomes subject to administration or goes into liquidation (otherwise than for the purpose of amalgamation or reconstruction) or an encumbrancer takes possession, or a receiver is appointed over any of the property or assets of the Hirer;
- (ii) the Hirer ceases or threatens to cease to carry on business;
- (iii) the Hirer is unable to pay his debts as they fall due; or

GENERAL CONDITIONS OF HIRE

(iv) Any diligence, execution or other legal process shall be levied on or against the Plant or against any premises where it is situated; then in each and every case the Contract shall automatically terminate without notice and without the Owner having any liability to the Hirer.

(c) The Hirer shall upon termination of the Contract under Conditions 14(a) or 14(b) pay to the Owner:-

(i) all arrears of Hire Charges then due under the Contract and all other sums accrued, due and unpaid by the Hirer to the Owner at the date of termination, together with interest payable under Condition 20 and any other sums due under any other agreement between the Owner and the Hirer; and

(ii) the cost of all repairs to the Plant required as at the date of termination (other than those for which the Owner has assumed responsibility under Condition 6).

(d) Termination of the Contract pursuant to Conditions 14(a) or 14(b) shall not affect any rights of the Owner or liabilities of the Hirer subsisting as at the date of termination.

(e) On termination of the Contract or expiry of the Period of Hire, the Hirer shall no longer be in possession of the Plant with the Owner's consent and shall (unless otherwise agreed with the Owner) forthwith return the Plant to the Owner at such address as the Owner may direct in good order and in good working condition and at the Hirer's expense and risk. Without prejudice to any other rights or remedies of the Owner under the Contract, the Owner may at any time after such termination, without notice, retake possession of the Plant for which purpose it shall be lawful for the Owner or his representatives to enter into or upon any premises or site where the Plant may be held, and the Hirer shall indemnify the Owner against all loss, damage, costs, or expenses so arising including in respect of third party claims.

15. OPERATED PLANT

The Hirer shall sign the operator's weekly time sheet, which shall be conclusive as to the working hours of the Plant, plus operator's driving and normal maintenance time. Operator's time spent on breakdown will be chargeable to the Hirer unless the repairs involved are necessary because of the fault of the Owner.

16. OUTRIGGERS AND STABILISERS

Any sound timber or other material supplied by the Owner for use with outriggers or stabilisers to the Plant is provided solely to assist the Hirer and expressly not to relieve him in any way from his legal, regulatory or contractual obligations to ensure adequate stability of Plant under imposed loading.

17. EXCLUSION OF WARRANTIES

All warranties, conditions or other terms implied by statute or common law with regard to the Plant, except as expressly provided in these Conditions, are expressly excluded to the fullest extent permitted by law.

18. LIMITATION OF LIABILITY

(a) Except for liability for death or personal injury arising from the Owner's negligence or fraudulent misrepresentation, the Owner's obligation to repair or replace the Plant as provided in Condition 6 shall constitute the full extent of the Owner's liability in respect of any loss or damage sustained by the Hirer;

(b) The Owner shall not be liable to the Hirer for any indirect or consequential loss or damage (whether for loss of profit, loss of business, depletion of goodwill or otherwise) costs, expenses or other claims for consequential compensation whatsoever (howsoever caused) which arise out of or in connection with the Contract.

19. CONSUMER CREDIT LEGISLATION

Where the Contract is one to which the Consumer Credit Act 1974 as amended or re-enacted from time to time would otherwise apply it is an essential condition of the hire (unless the Owner and Hirer expressly agree in writing that the Contract shall subsist for a period of greater than 80 days) that it will terminate on the expiry of 80 days from its commencement and that there shall be no right or option on the part of the Hirer to require the Owner to extend the Contract or enter into a new contract of hire with the Owner. This clause is without prejudice to the provisions for termination contained in Condition 14.

20. INTEREST

All invoices are payable within 30 days of the invoice date. Time of payment shall be of the essence of these Conditions. In the event of late payment then, without prejudice to any other right or remedy, the Owner shall be entitled to charge interest at the rate of 3% per annum above the base rate of the Royal Bank of Scotland plc from time to time (both before and after any judgement) from the due date until settlement is received in full.

21. GOVERNMENT REGULATION

During the Period of Hire the Hirer shall be responsible for complying with statutory provisions or regulations in relation to the operation and use of the Plant.

22. DATA PROTECTION

Where the Hirer is a sole trader:-

(a) the Owner will take all reasonable precautions to keep the details of the Hirer's order and payment secure, but unless the Owner is negligent, the Owner shall not be liable for unauthorised access to information supplied by the Hirer; and

(b) the Owner will only use the information the Hirer provides about himself for the purpose of fulfilling the Owner's obligations under the Contract, unless the Hirer agrees otherwise. The Hirer may correct any information about himself or ask for information about himself to be deleted, by giving the Owner written notice in accordance with Condition 23(d).

23. MISCELLANEOUS

(a) The Owner shall use all reasonable endeavours to discharge its obligations under these Conditions in a prompt and efficient manner but does not accept responsibility for any failure or delay caused by circumstances beyond its control.

(b) No waiver by the Owner of any breach of these Conditions by the Hirer shall be considered as a waiver of any subsequent breach.

(c) If any provision of these Conditions is held by any competent authority to be invalid or unenforceable in whole or in part the validity of the other provisions of these Conditions and the remainder of the provision in question shall not be affected.

(d) Any notice required or permitted under these Conditions shall be in writing and shall be served by personal delivery, email (to the email addresses used by the Hirer and Owner when the order is placed) or by pre-paid first class post addressed to the other party at its registered office, principal place of business or such other address as has been notified pursuant to this provision to the party giving the notice. Any such notice shall be deemed to have been received if delivered personally, at the time of delivery, if served by email, at the time of transmission and in case of prepaid first class post, 48 hours from date of posting.

(e) The Owner may assign, transfer, charge or dispose of any of its rights, or sub-contract or otherwise delegate any of its obligations under the Contract.

(f) The Hirer may not assign, transfer, sub-contract or otherwise dispose of the benefit or burden of the Contract to a third party without the prior written consent of the Owner.

(g) A certificate signed for and on behalf of the Owner shall be sufficient to fix and ascertain the sums due by the Hirer to the Owner under the Contract and shall be conclusive of the amounts due.

(h) The Hirer consents to registration of the Contract and any certificate under Condition 23(g) for preservation and execution.

24. DISPUTE RESOLUTION

(a) The Scheme for Construction Contracts (Scotland) Regulations 1998 as amended or re-enacted from time to time (whether before or after the date of the Contract) ("the Regulations") shall apply to the Contract. The Contract may specify the person (if any) to act as adjudicator. For the purposes of the Regulations, the specified nominating body to select any adjudicator shall be the SPOA acting through its President from time to time.

(b) The Owner and Hirer shall comply forthwith with any decision of the adjudicator and where court action follows thereon, shall not defend such action and shall consent to decree and submit to enforcement in respect of any such decision, in each case without any defence, set-off, counter claim, abatement or deduction.

(c) Where the Owner, Hirer or adjudicator wishes to register a decision of the adjudicator for execution in the Books of Council and Session, any other party shall, on being requested to do so, forthwith consent to such registration by subscribing the decision before a witness.

25. GOVERNING LAW

These Conditions shall be governed and construed in accordance with the Law of Scotland and the Hirer hereby submits to the non-exclusive jurisdiction of the Scottish Courts.

CATALOGUE INDEX

DESCRIPTION

	PAGE
Contents	3
Welcome	4
Our Structure & Leadership	6
Depot Locations	8
About Us	10
Mission & Values	11
Innovative Solutions	12
Jarvie Delivers	14
A Different Perspective	16
Life Cycle	18
Health & Safety	20

ECO- FLEET

2T Electric Excavator	22
Manitou MRT2660E Oxygen	22
Solar Welfare Units	22
Electric Vans	22
JCB 1TE Electric Dumper	23
JCB 525-60E 6m Electric Telehandler	23
ST-9 (LED-4) Solar-Only Lighting Tower	23
Hushpods	23

TRANSPORT

Transport Solutions/Tractor Unit & Crane Mounted Truck Hire	25
---	----

ACCESS PLATFORMS

8m Electric Scissor Lift	27
12m Electric Scissor Lift	27
15.5m High Reach Zero Emission Electric Scissor Lift	27
10m Access Platform	28
14m Access Platform	28
14m Hybrid Electric Platform	28
15.5m Access Platform	28
18m Access Platform	28
9.8m Access Platform	28

DUMPERS

Wheeled Dumpers

1 Tonne Hi-Tip	31
3 Tonne Swivel	31
6 Tonne Straight Tip	31

6 Tonne Swivel	31
9 Tonne Straight Tip	32
9 Tonne Swivel	32
9 Tonne Swivel Cabbed	32
10 Tonne Straight Tip	32
10 Tonne Cabbed	32

Accessories

Road Tax Lighting Kit	32
Grass Tyres	32
HFR	32
VCAS	32

Tracked Dumpers

Hi-Tip Tracked Barrow	33
3.0 Tonne Swivel Skip Tracked Dumper	33
4.0 Tonne Tracked Dumper	33
7.5 Tonne Tracked Dumper	33
9 Tonne Tracked Dumper	33
6.5 Tonne Straight Tip Tracked Dumper	34
11 Tonne Straight Tip Tracked Dumper	34
Fully rotating rubber-tracked dumper/carrier	34

Articulated Dump Trucks

12 Tonne Articulated Dump Trucks	35
20 Tonne Articulated Dump Trucks	35
30 Tonne Articulated Dump Trucks	35

EXCAVATORS

Mini Excavators

800kg Micro Excavator	37
1.5 Tonne Mini Excavator	37
1.6 Tonne Mini Excavator	37
2 Tonne Mini Excavator	37
3 Tonne Mini Excavator	37

Midi Excavators

5 Tonne Excavator Zero Tail	38
8.2 Tonne Midi Excavator	38
8.5 Tonne Midi Excavator	38

Accessories

Height & Slew	38
LGP Tracks	38

CATALOGUE INDEX (CONT.)

Large Excavators

13/14 Tonne Tracked Excavator	39
14 Tonne Tracked Excavator	39
15/16 Tonne Tracked Excavator	39
20/22 Tonne Tracked Excavator	39

Backhoe Loaders/180 Excavators 6 Tonne Backhoe Loader

6 Tonne Backhoe Loader	40
8 Tonne Backhoe Loader	40

Wheeled Excavators

10/11 Tonne Wheeled Excavator	41
16/17 Tonne Wheeled Excavator	41

Hydraulic Breakers

700kg < 1000kg Excavator	42
1.5 Tonne < 2.0 Tonne Excavator	42
2.5 Tonne < 3.2 Tonne Excavator	42
3.5 Tonne < 6.0 Tonne Excavator	42
8.0 Tonne < 11.0 Tonne Excavator	42
13.0 Tonne < 15.0 Tonne Excavator	42
16.0 Tonne < 22.0 Tonne Excavator	42

Excavator Accessories

Hydraulic Breakers	43
Pallet Forks Attachments	43
Hydraulic Grabs & Grapples	43
Compactor Plates	43
Hydraulic Grabs & Grapples	43
Tilting Ditching Buckets	43
180 Degree Powertilt Attachments	43
Tilt Rotator Attachments	43
Ripper Teeth	43
Special Buckets - Tapazoidal, Fibre, Riddle, Screening, Concrete	43

TELEHANDLERS & FORKLIFTS

Forklifts

2.0 Tonne - 2.5 Tonne C/Balance Forktruck, Electric/Diesel	45
2.6 Tonne Masted Forklift	45
2.5 Tonne C/Balance Forktrucks	45

Telehandlers

4m Compact Telehandler	46
6m Compact Telehandler	46

7m Telehandler	46
9m Telehandler	46
12m Telehandler	47
14m Telehandler	47
18m Telehandlers	47
Why Choose Jarvie Plant	48

Telehandler Attachments

Fork Extension Sleeves	50
Powerbrush Forklift Sweeper	50
General Purpose Buckets	50
Fork Hooks	50
Mechanical Block Grabs	50
Autolock Tipping Skip	50
Mortar Skips	50
Extendable Roof Truss Handlers	50

Rotating Telehandlers

25m 5 Tonne Rotating Telehandler	53
26m 5 Tonne Rotating Telehandler	53
26m 6 Tonne Rotating Telehandler	53
26m 6 Tonne Hybrid Rotating Telehandler	53
30m 5 Tonne Rotating Telehandler	53
30m 6 Tonne Rotating Telehandler	53
35m 7 Tonne Rotating Telehandlers	53
Case Study	54
Rotation Charts	55
Rotational Telehandler Accessories	56

ROLLERS

28" Roller Breaker & Trailer	59
Trench/Utility Roller	59
Compact Padfoot Roller	59

Ride-on Tandem Roller

0.8m Ride-on Tandem Roller	60
1m Ride-on Tandem Roller	60
1.2m Ride-on Tandem Roller	60
1.3m Ride-on Tandem	60
10 Tonne Tandem Vibrating Roller	60
10 Tonne Tricycle Roller	60

CATALOGUE INDEX (CONT.)

Self-Propelled Rollers

12 Tonne/13 Tonne Self Propelled Roller	61
16 Tonne Self-propelled Roller	61

POWER & LIGHTING

Generators	63
Battery Power Storage System	64

Power Stores

40kVA Power Store	66
100kVA Power Store	66

Lighting

Diesel Powered LED Lighting Tower	67
9m Mobile Tower Light	67

BOWSERS & COMPRESSORS

Highway Bowsers

950 litre Fully Bunded Hiway Fuel Bowser	69
2,000 litre Twin Axle Fully Bunded Hiway Fuel Bowser	69
1,000 litre Poly Hiway Water Bowser	69
2,000 litre Poly Hiway Water Bowser	69

Static Tanks

1,000 litre Bunded Site Fuel Tank	69
2,000 litre Bunded Site Fuel Tank	69
4,000 - 20,000 litre Bulk Fuel Tanks	69

Compressors

140cfm Bunded Compressors	70
260cfm Compressors	70
400cfm Hi-Way Compressors	70
400cfm CVSA Hi-Way Compressors	70
Electric Compressor	70

Compressor Tools

Light Pick	71
Vibrating Reduced Light Pick	71
Light Chipping Hammer	71
Light Rotary Hammer	71
Air Pistol Drill	71
Vibrating Damped Medium Breaker	71
Air Poker	71
Case Study	72

SMALL PLANT

General Equipment

Stihl Hand Saw	74
450mm Petrol Floor Saw	74
JCB Beaver Hydraulic Power Pack	74
Hydraulic Breaker with 7m Hydraulic Hose	74
Cable Detection	74
Steel Road Plate/Anti Skid Road Plate	74
Hydraulic Drill	74
Cobra Petrol Breaker	74
240V Convector Heater	74
Infrared Heater 110V 2kw	74
Herras Fencing	74
Gas Monitor	74
100V Pencil Grinder	74
Drill	74
0.5" Impact Drill	74
100V Hammer Drill	74
110V Kango Breaker	74
Dehumidifier	74
2" Submersible Pump	74
2" Petrol Pump	74
Fan Heater	74
100V Red Rad Heater	74
Cordless Drill, Battery + Charger	74

Rammers & Plates

45kg 300mm Petrol Vibrating Plate	76
60kg 330mm Vibrating Plater with Water Tank	76
400mm Vibrating Plate	76
169kg 460mm Forward/Reverse diesel Vibrating Plate	76
Rammer 160mm Foot	76
Augers & Shears	76

Kerb Lifting Equipment

P-VPH Batter/Vacuum Handler	77
PT Vacuum Stone Magnet	77
TSZ-Uni Kerb Lifter	77
Diesel Vacuum, Block Lifter & Trailer	77

CATALOGUE INDEX (CONT.)

Concrete Equipment

Tubmix Mixer	77
4/3 Tip-up Petrol Mixer with Stand	77
7/5 Diesel Mixer with Electric Start Electric 110V HF Poker	77
Electric 110V HF Poker	77
Flex Drive Poker 1" - 3.5"	77

ACCOMMODATION

Eco Range

Eco Settler - 13' Mobile Unit	80
Eco Voyager - 16' Mobile Unit	81
Eco Pilot - 16' Mobile Unit	81
Solar Pilot - 16' Mobile Unit	82

Welfare Range

Admiral - 24' Welfare Unit	83
Harbour - 20' Welfare Unit	84
Island - 25' Welfare Unit	85
Eco Island - 24' Welfare Unit	86
Commander - 28' Welfare Unit (Canteen & Office Layout)	87
Envoy - 32' Welfare Unit	88

High Secure Accommodation

32' x 10' Hight Security Units	90
24' x 9' Hight Security Units	92
Linked Units	94
20' / 16' / 12' High Security Units	96
High Secure Toilet Range	98
Fire Rated	100
Blast Rated	101
Night Rest Sleeper Units	102
Stores	104
Ancillaries/Accessories	106
Accommodation Services We Provide	107

JPX Modular Buildings

Stacked Steel Calm	109
8on8 JPX Modular Building	109
4on4 JPX Modular Building	110
6on6 JPX Modular Building	110
8on8 JPX Modular Building	110
3 Storey JPX Modular Building	110

VEHICLES

Cars

Small Car	113
Economy Car	113
Compact Family Car	113
Standard Size Car	113
People Carrier	113
Sports Utility Vehicle	113

Buses

9 Seat Minibus	114
12 Seat Minibus	114
17 Seat Minibus	114
4WD Pickup	115
4WD Double Cab Pickup	115
3.5 Tonne GVW Pickup	115
3.5 Tonne GVW Tipper	115
3.5 Tonne GVW Crew Cab Tipper	115
3.5 Tonne GVW Pickup with Tail Lift	115

Vans

Cube Van	116
3 Seats Cube Van	116
5 Seat Van	116
750kg Van	116
1 Tonne Panel Van	116
Crew Van	116
2.9 Tonne LWB Panel Van	116
3.5 Tonne LWB Panel Van	116
3.5 Tonne Jumbo Van	116
3.5 Tonne Luton with Tail Lift	116
Welfare Van - 7 Seats	116

TERMS & CONDITIONS

118

INDEX

128

CONTACT DETAILS

132



Scan here for
Total Site Solutions

DEPOT LOCATIONS

ABERDEEN

GREENBANK ROAD
EAST TULLOS INDUSTRIAL ESTATE
AB12 3BQ
01224 510 101
ABERDEEN@JARVIEPLANT.CO.UK

EDINBURGH

14 QUEEN ANNE DRIVE, NEWBRIDGE
EH28 8LH
0131 453 5311
EDINBURGH@JARVIEPLANT.CO.UK

MANCHESTER

CHADDOCK LANE ASTLEY
M29 7JS
0161 302 7030
MANCHESTER@JARVIEPLANT.CO.UK

COWDENBEATH

WOODEND INDUSTRIAL ESTATE
KY4 8HJ
01383 514444
COWDENBEATH@JARVIEPLANT.CO.UK

GLASGOW

295 EDMISTON DRIVE
G51 3RN
0141 445 2121
GLASGOW@JARVIEPLANT.CO.UK

NAIRN

UNIT 3, BALMAKEITH BUSINESS
PARK, NAIRN, IV12 5QR
0345 208 4444
HIRE@JARVIEPLANT.CO.UK

DUNDEE

DUNSINANE AVENUE
DD2 3QA
01382 270 101
DUNDEE@JARVIEPLANT.CO.UK

GRANGEMOUTH

DALGRAIN ROAD,
GRANGEMOUTH FK3 8ET
01324 473 321
HIRE@JARVIEPLANT.CO.UK

PAISLEY

64 INCHINNAN ROAD,
PA3 2RP
0141 887 0044
PAISLEY@JARVIEPLANT.CO.UK

HIRE ENQUIRIES
HIRE@JARVIEPLANT.CO.UK

SALES ENQUIRIES
SALES@JARVIEPLANT.CO.UK

HIRE LINE
0345 208 4444

Hire Solutions Delivered

jarvieplant.co.uk